



Warnings must be followed carefully to avoid bodily injury.



Cautions must be observed to avoid damage to your equipment.

# Paper Jam Guide

When the LCD panel displays the Jam XXX error message, choose the appropriate description to clear the jammed paper.  
For more information, see the Online Reference Guide.

## Jam A

1

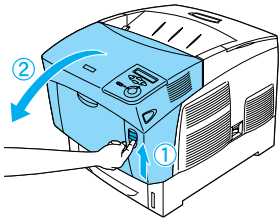

2

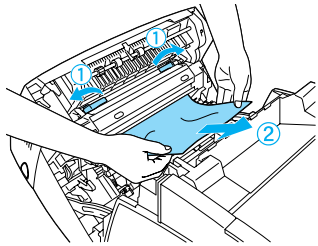
**Warning:**

Do not touch the fuser, which is marked CAUTION HIGH TEMPERATURE, or the surrounding areas. If the printer has been in use, the fuser and the surrounding areas may be very hot.

3

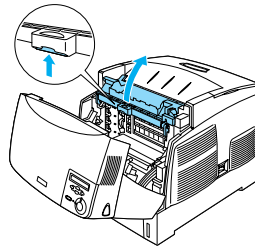

4

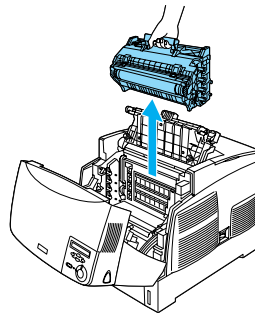
**Caution:**

Be careful not to scratch the surface of the drum. Also, avoid touching the drum, since oil from your skin may permanently damage its surface and affect print quality.

5

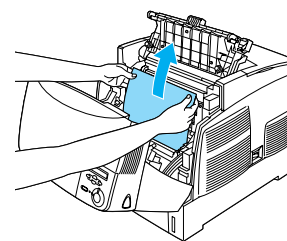

6

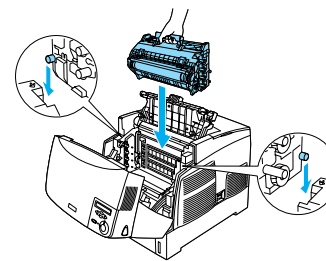

7

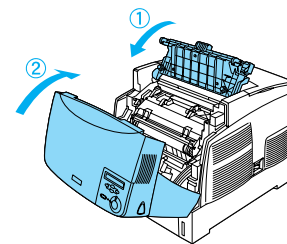

## Jam at the MP tray

Remove the paper from the MP tray and remove any jammed paper. Open and close cover A to clear the message on the LCD panel, then reload the paper. The printer resumes printing from the page that jammed.

## Jam B

1

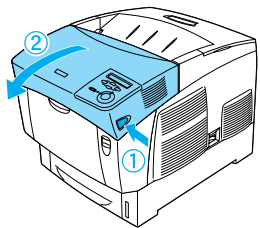

2

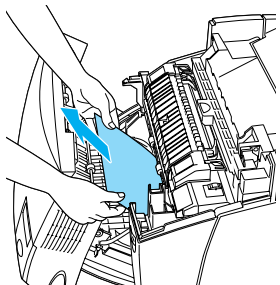

**Warning:**

Do not touch the fuser, which is marked CAUTION HIGH TEMPERATURE, or the surrounding areas. If the printer has been in use, the fuser and the surrounding areas may be very hot.

3

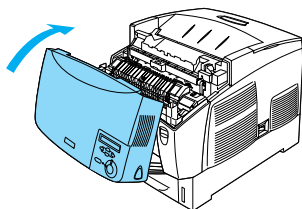

## Jam AC

1

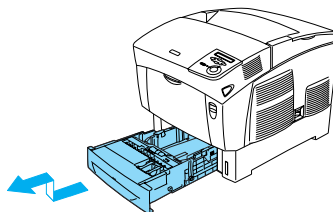

2

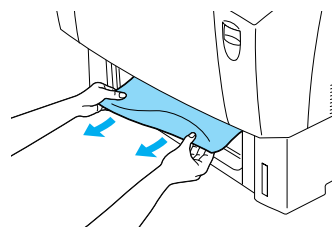

3

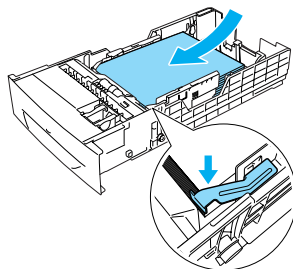

4

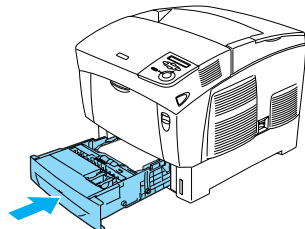

5

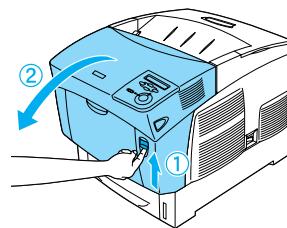

6

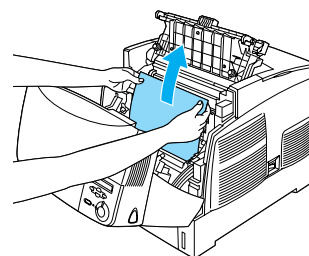

**Warning:**

Do not touch the fuser, which is marked CAUTION HIGH TEMPERATURE, or the surrounding areas. If the printer has been in use, the fuser and the surrounding areas may be very hot.

7

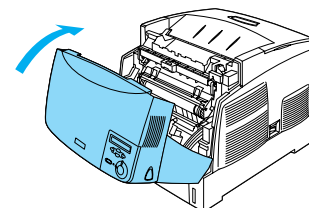

When a paper jam occurs repeatedly at the paper cassettes, see the Online Reference Guide.

## Jam ABC

To clear the paper jam, first clear at Jam AC, and then clear at Jam B.

## Jam AB

1

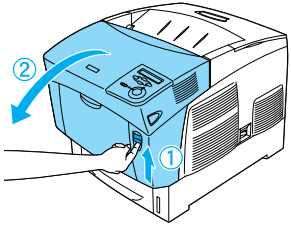

2

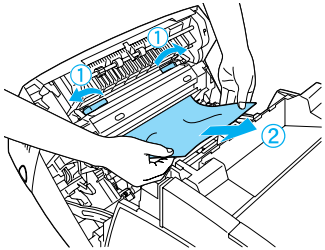

3

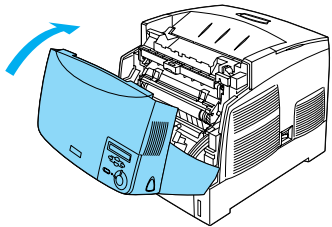

4

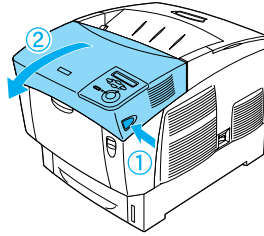

5

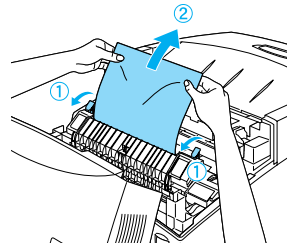

6

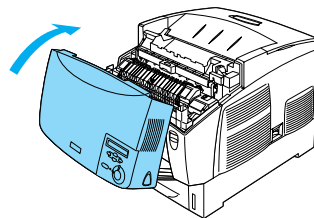

**Warning:**

Do not touch the fuser, which is marked CAUTION HIGH TEMPERATURE, or the surrounding areas. If the printer has been in use, the fuser and the surrounding areas may be very hot.



**Warning:**

Do not touch the fuser, which is marked CAUTION HIGH TEMPERATURE, or the surrounding areas. If the printer has been in use, the fuser and the surrounding areas may be very hot.