

SC-S80600 Series
SC-S80600L Series
SC-S60600 Series
SC-S60600L Series
SC-S40600 Series

Operator's Guide

Copyrights and Trademarks

Copyrights and Trademarks

No part of this publication may be reproduced, stored in a retrieval system, or transmitted in any form or by any means, electronic, mechanical, photocopying, recording, or otherwise, without the prior written permission of Seiko Epson Corporation. The information contained herein is designed only for use with this Epson printer. Epson is not responsible for any use of this information as applied to other printers.

Neither Seiko Epson Corporation nor its affiliates shall be liable to the purchaser of this product or third parties for damages, losses, costs, or expenses incurred by the purchaser or third parties as a result of accident, misuse, or abuse of this product or unauthorized modifications, repairs, or alterations to this product, or (excluding the U.S.) failure to strictly comply with Seiko Epson Corporation's operating and maintenance instructions.

Seiko Epson Corporation shall not be liable for any damages or problems arising from the use of any options or any consumable products other than those designated as Original Epson Products or Epson Approved Products by Seiko Epson Corporation.

Seiko Epson Corporation shall not be held liable for any damage resulting from electromagnetic interference that occurs from the use of any interface cables other than those designated as Epson Approved Products by Seiko Epson Corporation.

EPSON and EPSON EXCEED YOUR VISION or EXCEED YOUR VISION and their logos are registered trademarks or trademarks of Seiko Epson Corporation.

Microsoft®, Windows®, and Windows Vista® are registered trademarks of Microsoft Corporation.

Mac, macOS are registered trademarks of Apple Inc.

Intel® is a registered trademark of Intel Corporation.

Bemcot™ is a trademark of Asahi Kasei Corporation.

YouTube® and the YouTube logo are registered trademarks or trademarks of YouTube, LLC.

General Notice: Other product names used herein are for identification purposes only and may be trademarks of their respective owners. Epson disclaims any and all rights in those marks.

© 2019 Seiko Epson Corporation. All rights reserved.

Contents

Contents

Copyrights and Trademarks

Notes on Manuals

Meaning of Symbols.	4
Illustrations.	4
Video Manuals.	4

Part Names

Front Section.	5
Ink unit (SC-S80600L Series/SC-S60600L Series)	6
Inside.	7
Back.	7

Basic Operations

Notes on Loading Media.	8
Notes on Loading Media.	8
Loading media.	8
Using the Auto Take-up Reel Unit.	14
Attaching the Roll Core.	14
Take-up with the Printed Side Facing Out.	17
Take-up with the Printed Side Facing In.	18
Settings for Loaded Media.	18
Removing the Take-up Roll.	20
Printing the Amount of Media Remaining.	20
Cutting Media.	20
Removing Media.	22

Maintenance

When to Perform Various Maintenance Operations.	23
Cleaning Locations and Cleaning Timing.	23
Locations of Consumables and Replacement Timing.	24
Other maintenance.	25
What You'll Need.	26
Precautions regarding maintenance.	26
Daily Cleaning.	27
Performing Regular Cleaning.	28
Using Ink Cleaner.	28
Moving the Print Head.	28
Cleaning Around the Print Head.	29
Cleaning Around the Caps.	30

Finishing Cleaning.	33
Cleaning Check Sheet.	34
Shaking and Replacing Ink Cartridges (SC- S80600 Series/SC-S60600 Series/SC-S40600 Series).	35
Shaking.	35
Replacement procedure.	35
Shaking and Replacing Ink Supply Units (SC- S80600L Series/SC-S60600L Series).	37
Shaking.	37
Replacement procedure.	38
Disposing of Waste Ink.	40
Preparing and Replacement Timing.	40
Waste Ink Counter.	40
Replacing the Waste Ink Bottle.	41
Replacing Maintenance Parts.	42
Preparing and Replacement Timing.	42
Replacement Procedure.	43
Disposal of used consumables.	45
Disposal.	45
Consumable Replacement Check Sheet.	46
Long-term Storage (Pre-storage Maintenance).	47
Pre-storage Maintenance Timing.	47
Performing Pre-storage Maintenance.	47
Restarting use of the printer.	48

Information on Maintenance Items

Ink cartridges.	49
Ink Supply Unit.	52
Maintenance Items.	55

Handling Ink Drops and Clogged Nozzles

Head Cleaning.	57
Auto Head Maintenance.	58

Notes on Manuals

Notes on Manuals

Meaning of Symbols

 Warning:	Warnings must be followed to avoid serious bodily injury.
---	---

 Caution:	Cautions must be followed to avoid bodily injury.
---	---

 Important:	Important must be followed to avoid damage to this product.
---	---

Note:	Notes contain useful or additional information on the operation of this product.
--------------	--

	Indicates related reference content.
---	--------------------------------------

Illustrations

Unless otherwise specified, the illustrations in this manual are for the SC-S40600 Series.

The illustrations may differ slightly from the model you are using. Please be aware of this when using the manual.

Video Manuals

These video manuals have been uploaded to YouTube and show you how to load media and perform maintenance.

To view the video manuals, click [Epson Video Manuals] from the top page of *Online Manual* or follow the steps below.

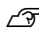
Opening Online Manuals  *General Information* (PDF)

Access the following QR codes from a smartphone or tablet device.



- 1 Access YouTube (<https://youtube.com>).
- 2 Enter "Epson Video Manuals (LFP)" in the search bar at the top of the screen.
- 3 Click [Epson Video Manuals (LFP)] in the search results.
- 4 Select the video you want to view from the list for the model you are using.

If the subtitles are not displayed when you play the video, click the subtitles icon shown in the image below.



Part Names

Part Names

Front Section

The illustration shows the SC-S60600 Series.

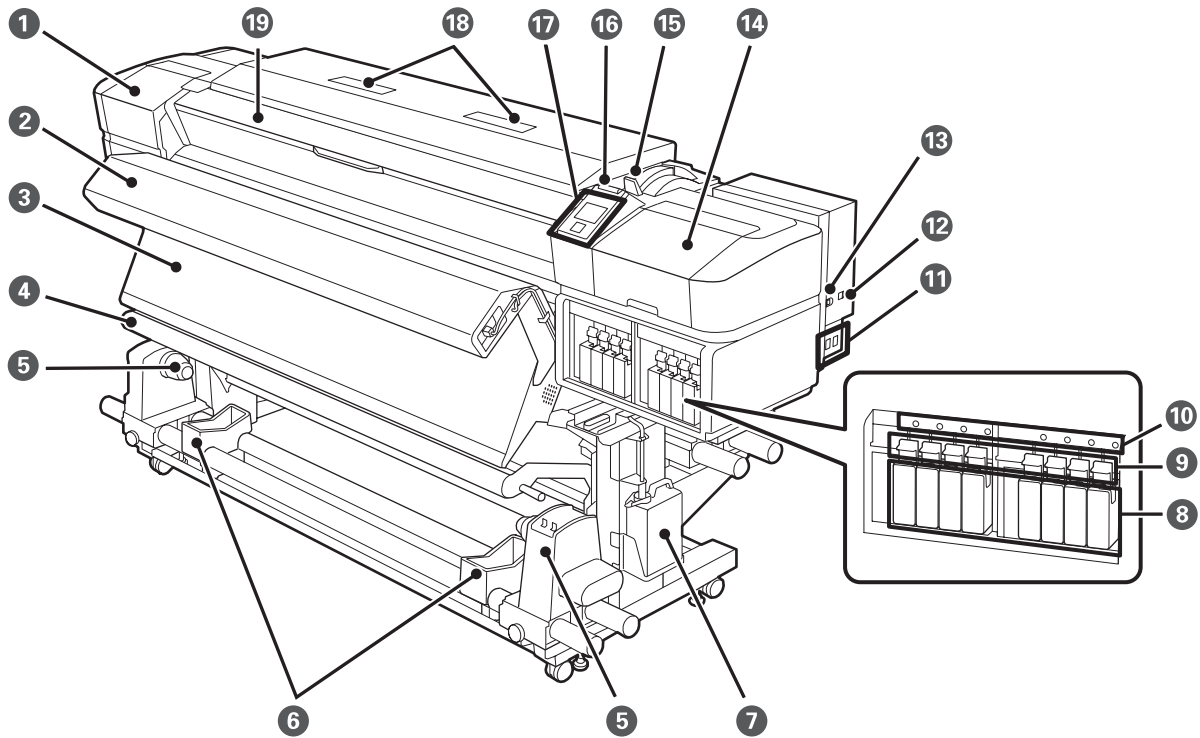

- | | | |
|--|--------------------------------------|-----------------------|
| ① Maintenance cover (left) | ⑧ Ink cartridges* ² | ⑮ Media loading lever |
| ② Additional print drying system* ¹ | ⑨ Lock lever* ² | ⑯ Alert lamp |
| ③ After heater | ⑩ Cartridge check lamp* ² | ⑰ Control panel |
| ④ Tension bar | ⑪ AC inlets #1/#2 | ⑱ Air filters |
| ⑤ Roll core holders left/right | ⑫ LAN port | ⑲ Front cover |
| ⑥ Roll supports (x2) | ⑬ USB port | |
| ⑦ Waste ink bottle | ⑭ Maintenance cover (right) | |

*1 Standard equipment on SC-S60600 Series/SC-S60600L Series. Optional equipment on SC-S40600 Series/SC-S80600 Series/SC-S80600L Series.

*2 The SC-S40600 Series only has a block on the right. Not available on SC-S80600L Series/SC-S60600L Series.

Part Names

Ink unit (SC-S80600L Series/SC-S60600L Series)

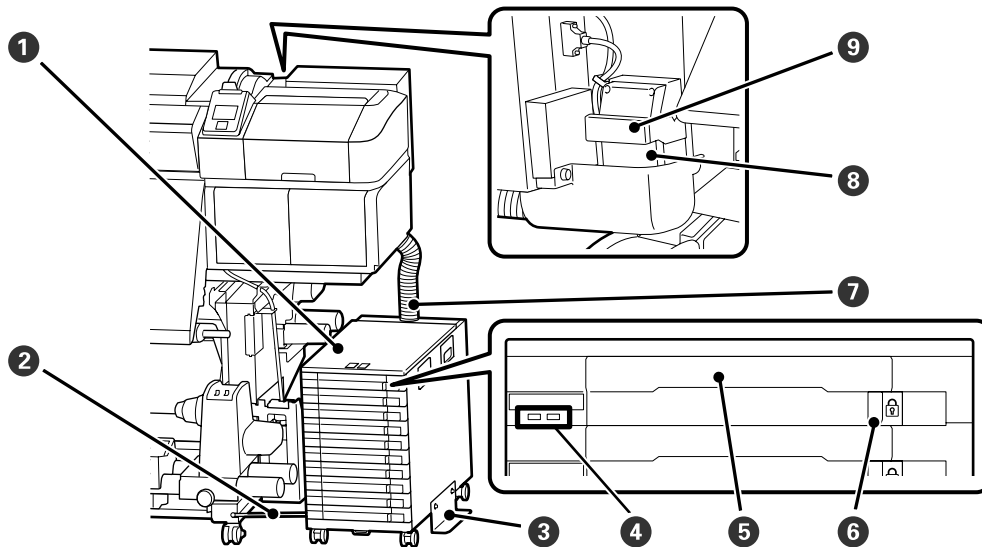

① Ink Unit

② Fixing wire

③ Overturn-prevention plate

④ LED lamp

⑤ Tray

⑥ Lock switch

⑦ Ink tube

⑧ Ink tube connector

⑨ Connector lock levers

Part Names

Inside

The illustration shows the SC-S60600 Series.

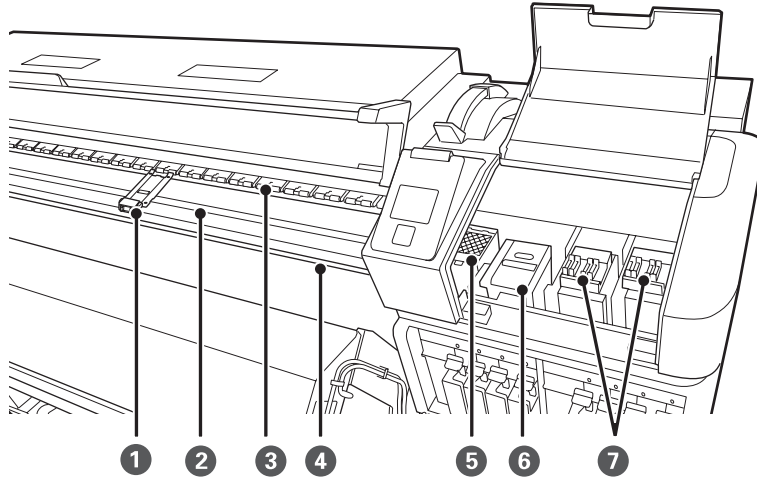

- ❶ Media edge plates (x2)
- ❷ Platen heater
- ❸ Pressure rollers
- ❹ Cutter groove
- ❺ Flushing pad
- ❻ Wiper unit
- ❼ Caps *1

*1 Only on the right for the SC-S40600 Series.

Back

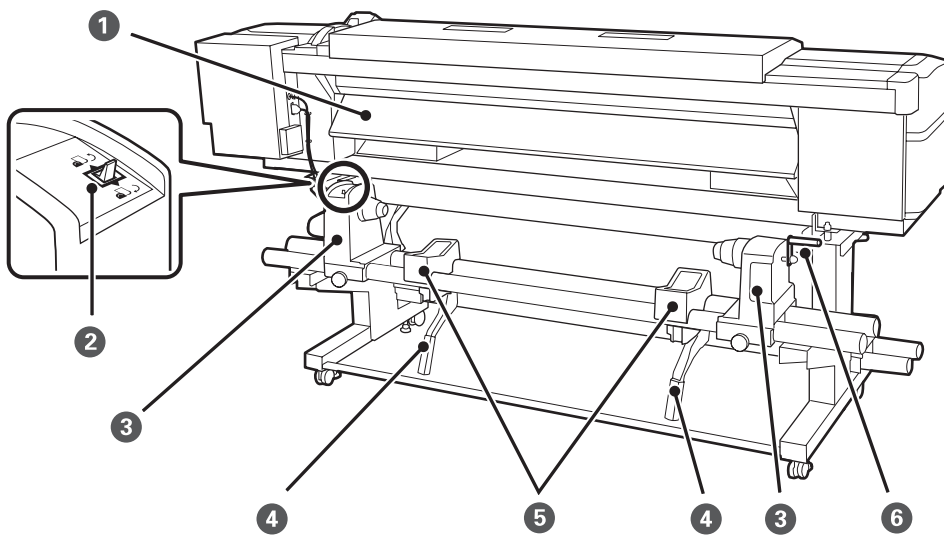

- ❶ Pre-heater
- ❷ Drive switch
- ❸ Roll holders left/right
- ❹ Lift lever (x2)
- ❺ Roll supports (x2)
- ❻ Handle

Basic Operations

Basic Operations

Notes on Loading Media

If the following points are not observed when handling media, small amounts of dust and lint may stick to the media surface and cause ink drops in the print results.

Do not place exposed media directly on the floor.
Media should be rewound and inserted in its original packaging for storage.

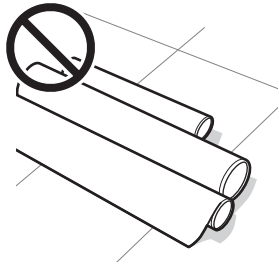

Do not carry media with the media surface pressed against clothing.

Handle media in its individual packaging until just before loading the media in the printer.

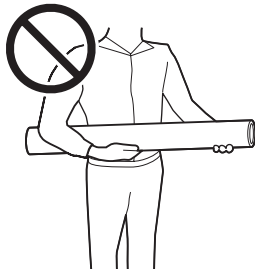

Notes on Loading Media

⚠ Caution:

- ❑ *The heaters and media edge plate may be hot; observe all necessary precautions. Failure to observe the necessary precautions could result in burns.*
- ❑ *Because the media is heavy, it should not be carried by one person.*
- ❑ *Be careful not to trap your hands or fingers when opening or closing the front cover. Failure to observe this precaution could result in injury.*
- ❑ *Do not rub your hands along the edges of the media. The edges of the media are sharp and can cause injury.*

Load the media just before printing.

The pressure rollers may crease media left in the printer. The media may also become wavy or curled, causing jams or resulting in the print head striking the media.

Do not load media if the right and left edges are uneven.

If media is loaded and the right and left edges of the roll are uneven, media feeding problems may cause the media to move around during printing. Either rewind to align the edges or use a roll without any issues.

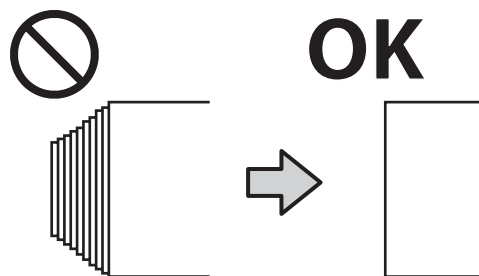

Loading media

You can check the procedure in a video on YouTube.

[👉 “Video Manuals” on page 4](#)

Basic Operations

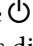
- 1 Press the  button, and then wait until **Load media.** is displayed on the screen.

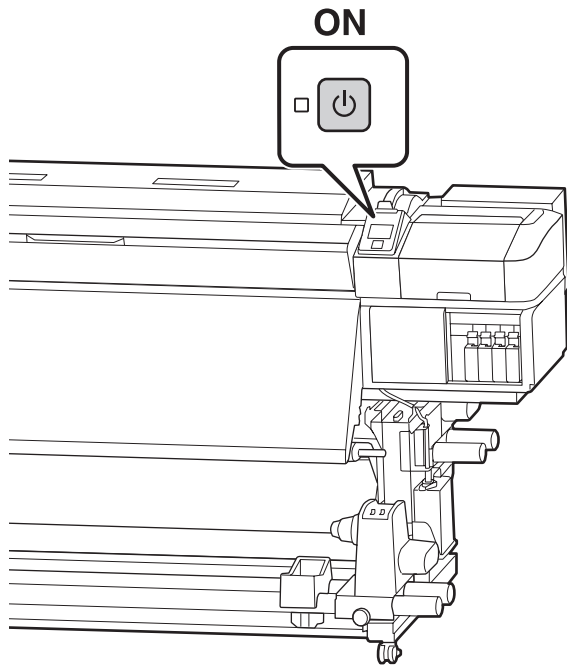

- 2 Open the front cover, and then raise the Media loading lever.

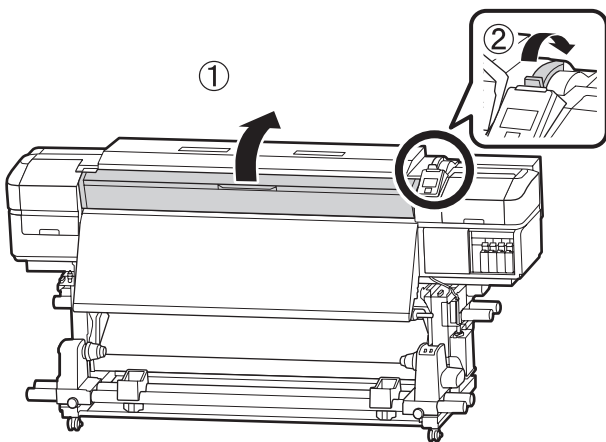

- 3 While holding the tabs of the media edge plate on both sides, move the plate out of the way toward both edges of the platen.

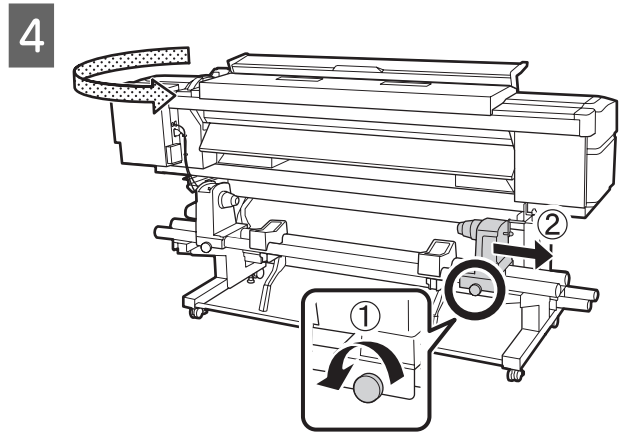
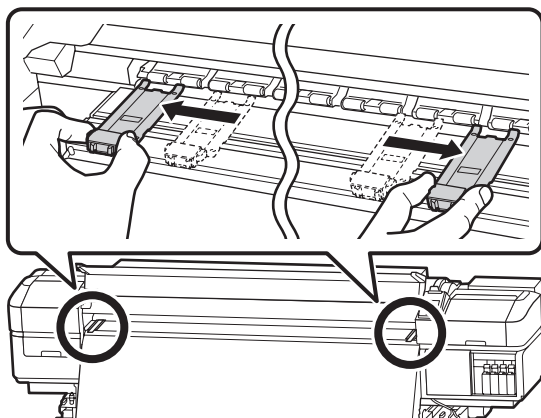

! Important:

If the right holder handle shaft is not visible, rotate the handle forward until it stops. The media can not be properly loaded if the handle shaft is not visible.

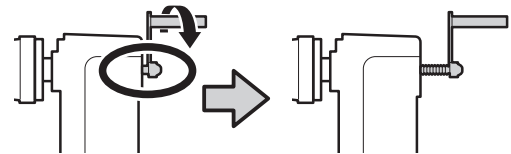

- 5 Move the roll holder to the set position according to the roll size of the media that will be loaded.

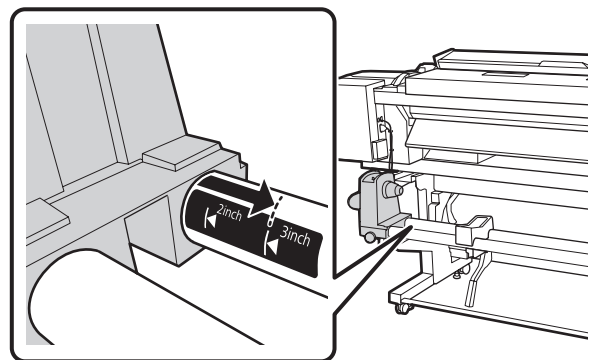

- 6 Tighten the screw until the screw no longer turns.

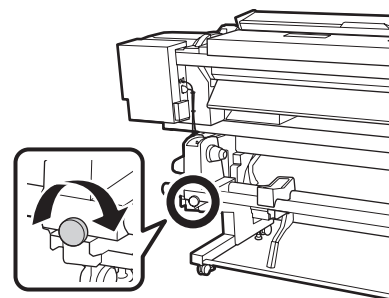

Basic Operations

7

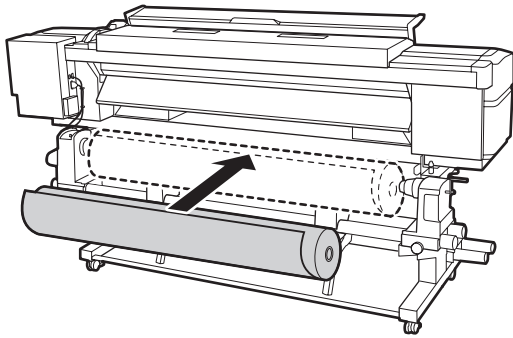

Note:

The method of placing the roll media varies as follows depending on how media is rolled.

Printable Side Out

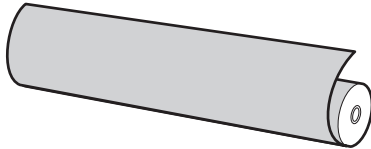

Printable Side In

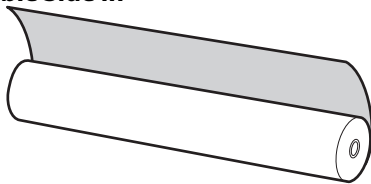

8

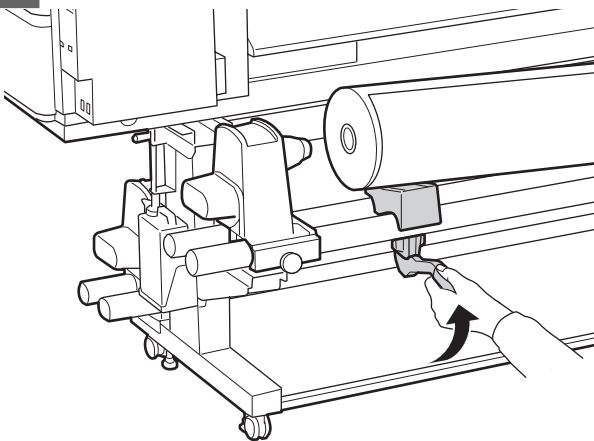

9

Firmly insert the roll core of the media onto the roll holder.

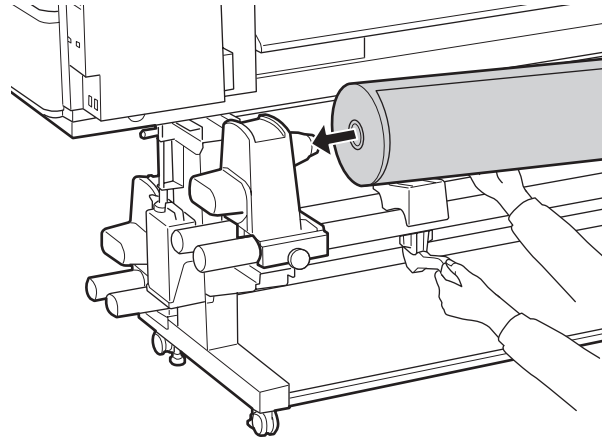

Note:

If the roll of media has an outer diameter which is less than 140 mm, the roll core will not reach the holder when raised using the lift lever.

Raise it with your hands, and insert the roll core onto the roll holder.

10

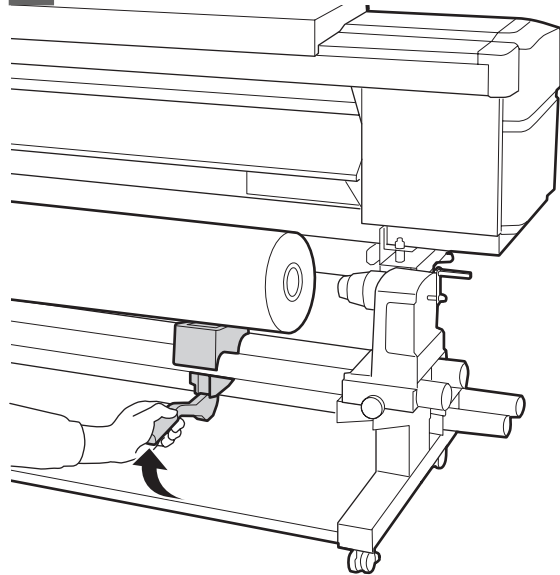

Basic Operations

11

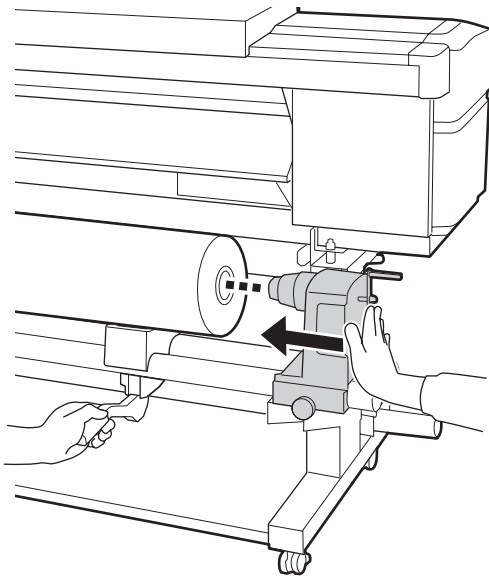

Note:

If the roll of media has an outer diameter which is less than 140 mm, the roll core will not reach the holder when raised using the lift lever.

Raise it with your hands, and insert the roll core onto the roll holder.

12

To ensure the roll holder is inserted into the roll core sufficiently, push it twice.

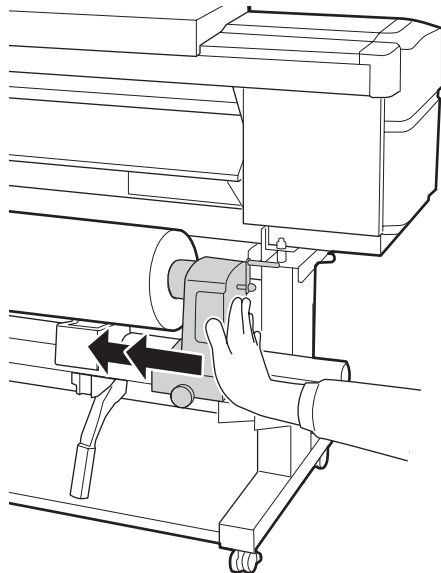

! Important:

If the roll holder is inserted into the roll core insufficiently, media is not fed correctly during printing because of slippage between the roll holder and roll core.

This may cause banding in the print results.

13

Tighten the screw until the screw no longer turns.

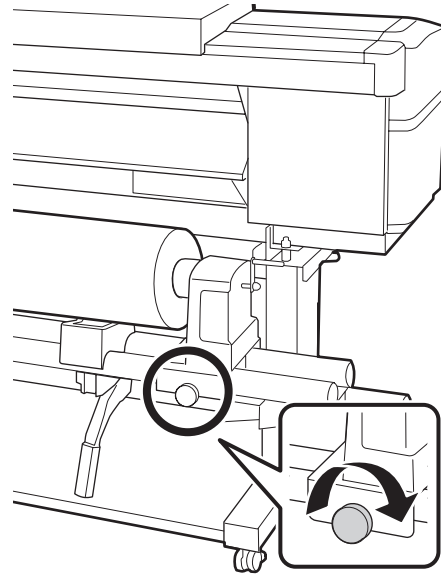

! Important:

If the roll holder screw is loose, the roll holder may move during printing. This could cause stripes and unevenness in the print results.

If the right and left edges of the roll are not aligned, realign them.

Basic Operations

- 14** Rotate the handle until part A in the illustration below is fully inserted.

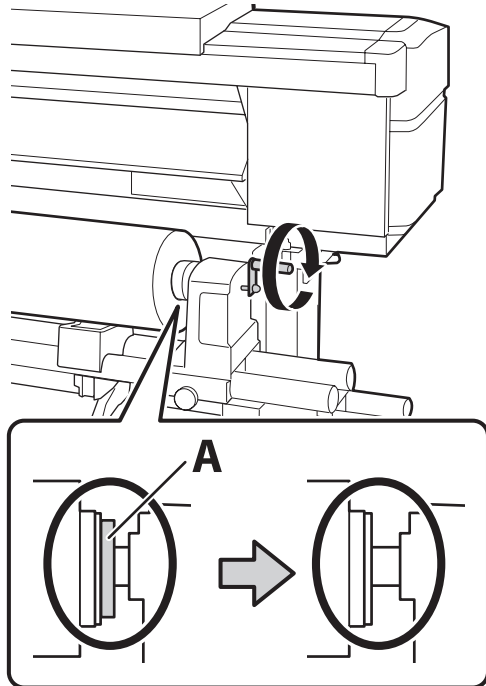

! Important:

Once part A is hidden, do not turn the handle any further. Failure to observe this precaution could damage the roll holder.

If part A is still visible even after the handle has been turned fully, rewind the handle. Loosen the roll holder screw on the right side, and then restart from Step 4.

- 15** Insert the media approximately 30 cm into the opening, then lower the media loading lever.

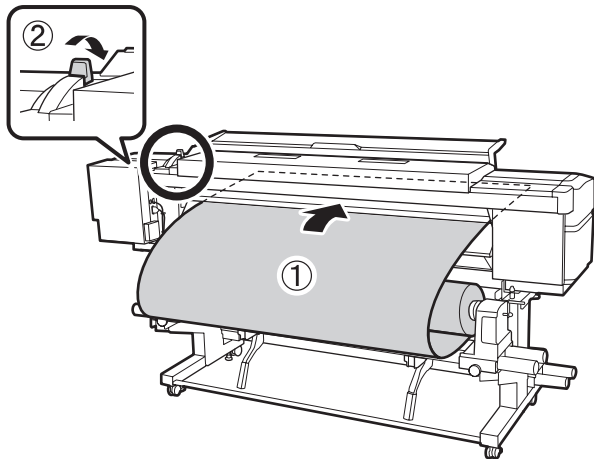

- 16** Confirm that the left edge of the media is within the range of the label's rectangle, as shown in the illustration below.

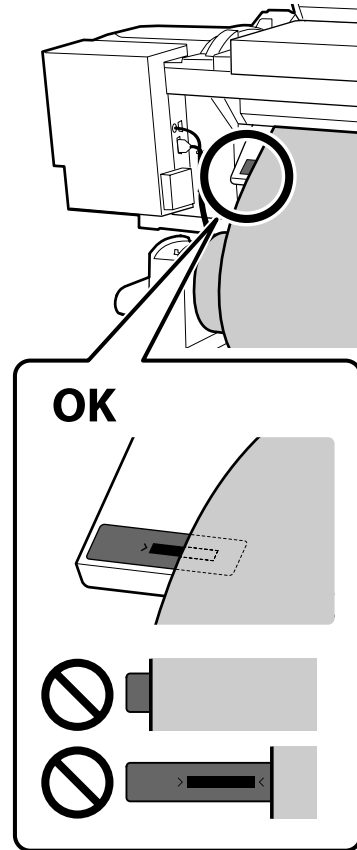

Note:

If the left edge of the media is not within the black square of the label, do steps 5 to 16 in reverse to adjust the position of the roll holder. Do not attempt to reposition the roll holders while they are inserted in the media.

- 17**

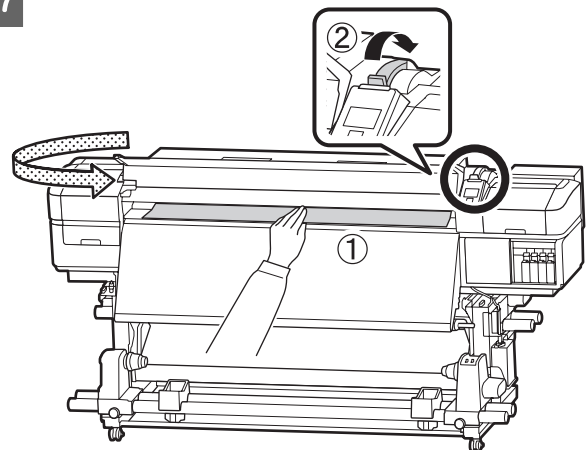

Basic Operations

- 18** Hold the center of the media in one hand, and pull it straight until it is aligned with the bottom edge of the label on the after heater.

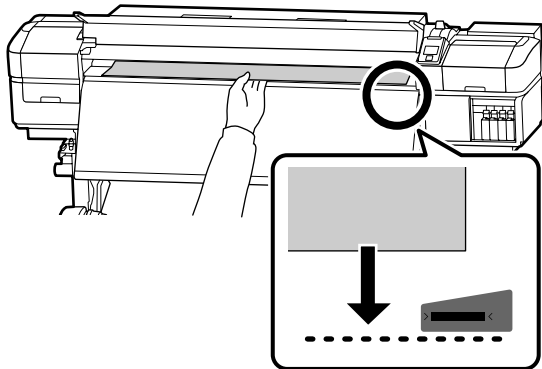

Do not pull the media with both hands. This could cause the media to skew or move around.

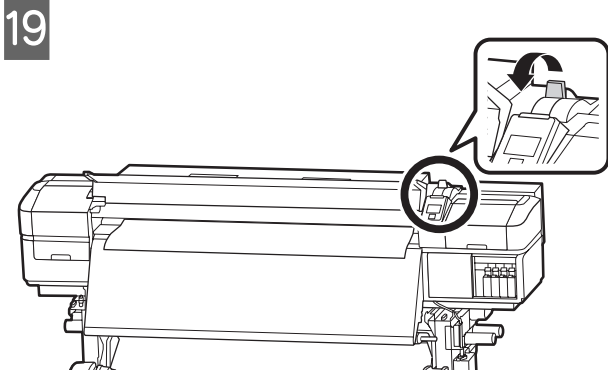
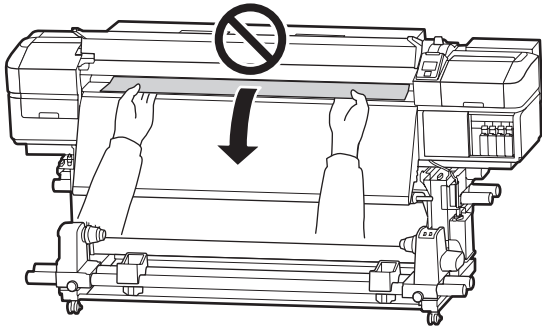

- 20** Tap lightly on both ends of the media, and check if there is a difference in tension between the left and right sides.

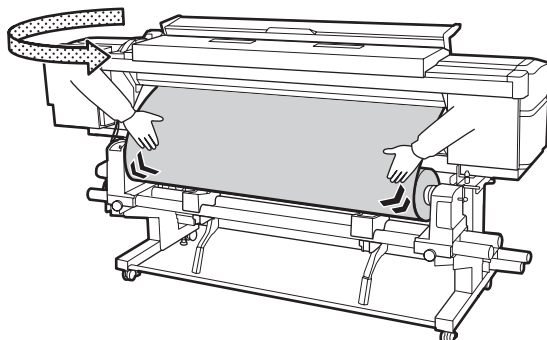

If there is a difference in tension, the media becomes loose.

From the front of the printer, raise the media loading lever, and correct the looseness in the media.

Once the looseness is corrected, lower the media loading lever.

- 21** While holding the tabs of the media edge plates on both sides, move the plate to the edge of the media. Adjust so that the edges of the media are aligned with the center of the round holes in the media edge plates.

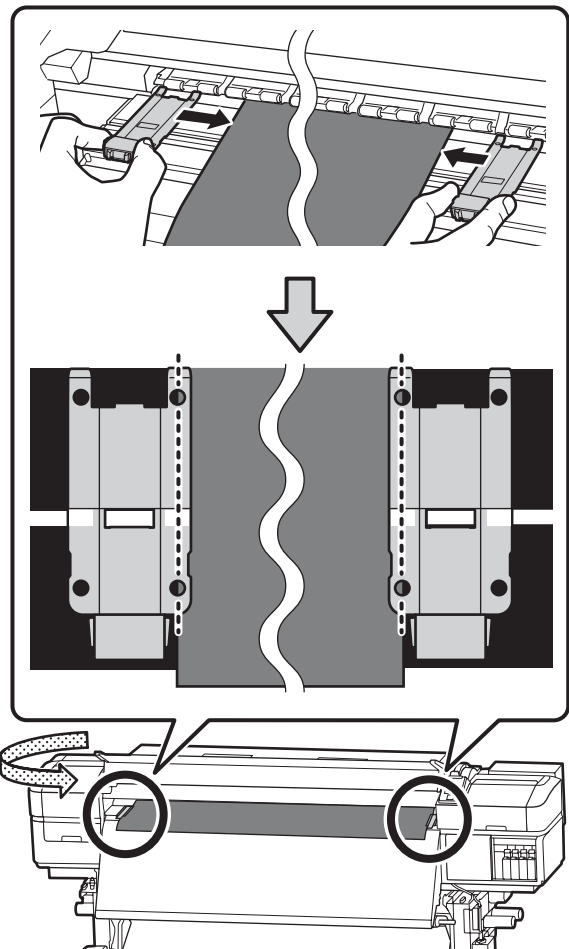

Basic Operations

! Important:

- Do not use the media edge plates with media that is 0.4 mm or thicker. The media edge plates could touch and damage the print head.
- Always position the plates so that the edges of the media are at the centers of the round holes. Incorrect positioning causes banding (horizontal banding, tint unevenness, or stripes) during printing.
- Move the media edge plates to the left and right edges of the platen when they are not in use.
- Do not use the media edge plates if the sides of the printed media are smudged or torn.

Taking-up with printed side in places the printed surface on the inside of the roll.

You can check the procedure in a video on YouTube.

[“Video Manuals” on page 4](#)

! Caution:

- Follow the instructions in the manual when loading media or roll cores or removing the take-up roll. Dropping media, roll cores, or take-up rolls could result in injury.
- Be sure that your hands or hair do not get caught in the Media Feeding Unit or Auto Take-up Reel Unit while it is operating. Failure to observe this precaution could result in injury.

22

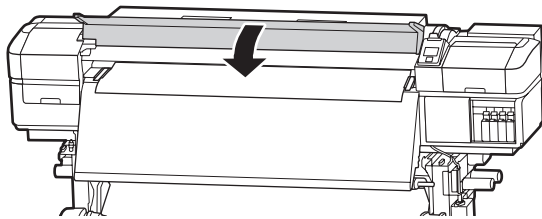

Using the Auto Take-up Reel Unit

The Auto Take-up Reel Unit automatically takes up media as it is printed. This improves the efficiency of unmanned operation.

The Auto Take-up Reel Unit for this printer can take up media in either of the following directions.

Printed side out

Printed side in

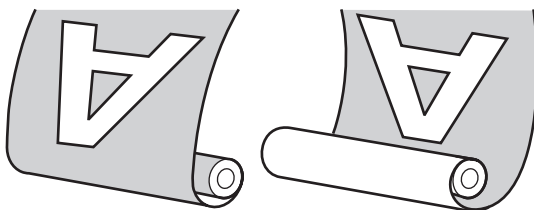

Taking-up with printed side out places the printed surface on the outside of the roll.

Attaching the Roll Core

Preparing

Use a roll core that is longer than the width of the media.

This allows the media to be taken up without protruding from the core.

Prepare the supplied paper tape.

We recommend this method for attaching media to the roll core due to the following advantages.

- It allows you to prevent misalignment of the roll at the left and the right edges, and to prevent the media from moving around, which provides a stable printing length for print jobs.
- Media is not wasted.

Basic Operations

- Media can be easily removed from the roll core after winding.

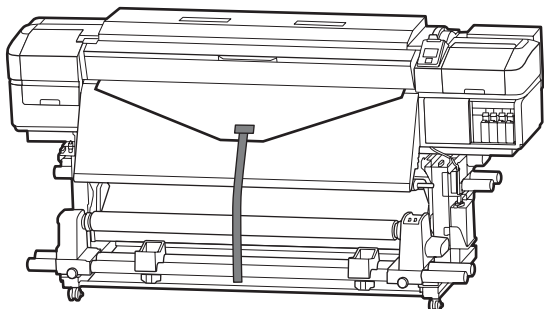

When the supplied paper tape runs out, purchase commercially available paper tape with a width of 20 to 25 mm (that is not easily stretched or cut). If you do not have any paper tape, cut media into pieces that are 20 to 25 mm wide and approximately 70 cm long.

Loading

- Keep the ▼ button pressed until the leading edge of the media reaches the center of the after heater.

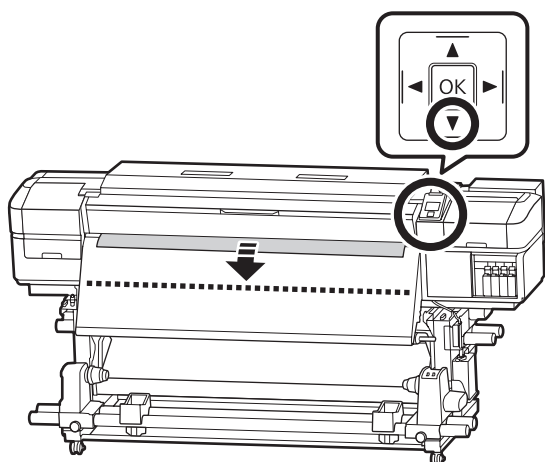

! **Important:**

Always press the ▼ button to feed the media. If the media is pulled by hand, the media may twist during take-up.

2

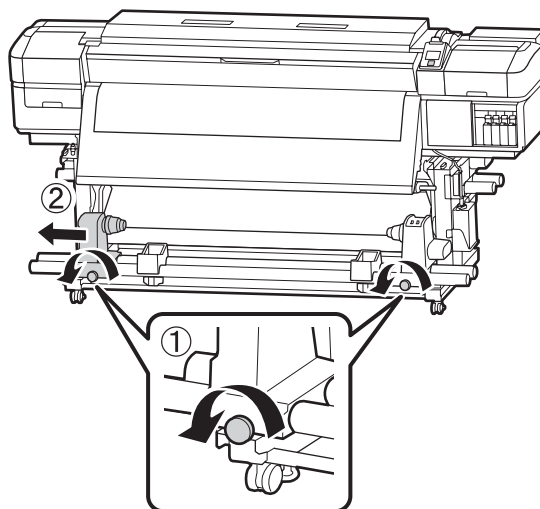

3

Align the roll core holder with the right edge of the media, and tighten the screw.

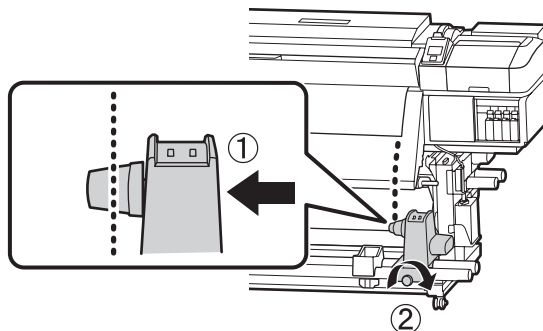

4

Insert the roll core onto the right holder.

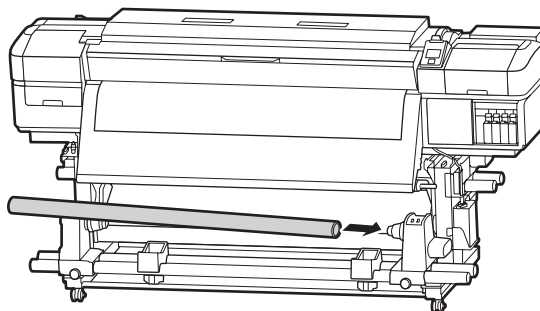

Basic Operations

- 5** Push the holder until part A shown in the illustration below is fully inserted, and tighten the screw.

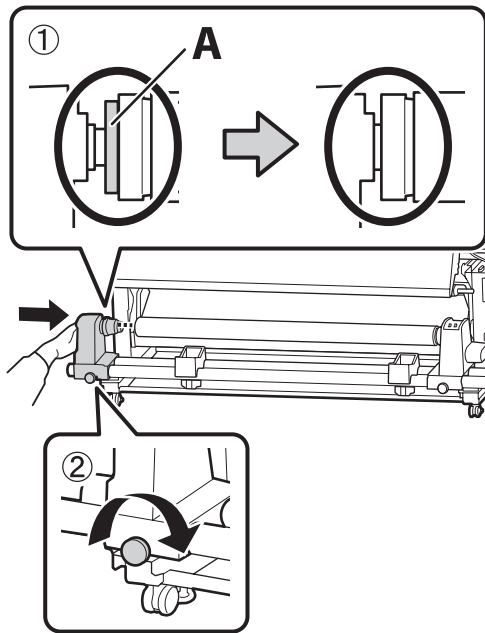

! Important:
 Stop when part A is no longer visible. The take-up reel unit may not function as expected if the holder is inserted too far.

- 6** Leave a 10 to 20 cm wide section in the center of the media, and cut at least 25 cm in height from the left and right corners of the media.

Cutting the media prevents feeding problems, such as the left and right corners of media being folded and caught at the start of take-up.

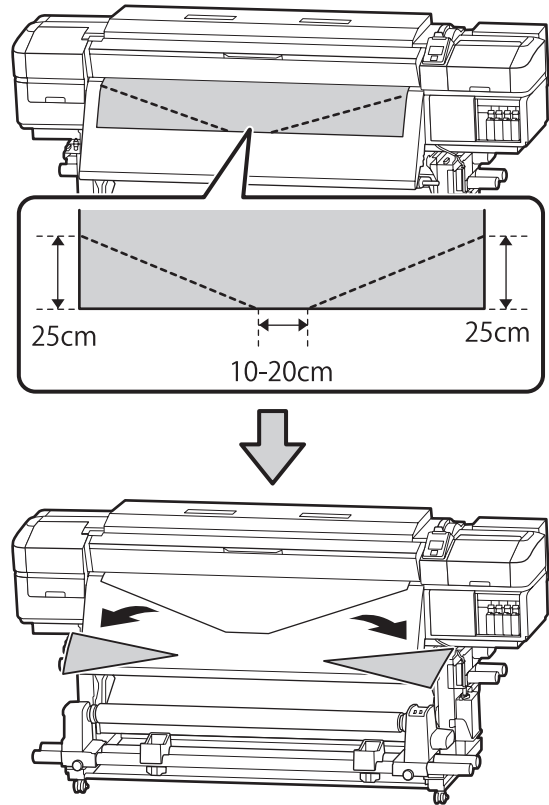

See either of the following steps depending on how the media is rolled.

For information on taking-up with printed side out, see [☞ “Take-up with the Printed Side Facing Out” on page 17.](#)

For information on taking-up with printed side in, see [☞ “Take-up with the Printed Side Facing In” on page 18.](#)

Basic Operations

Take-up with the Printed Side Facing Out

- 1 Cut the paper tape approximately 70 cm in length, and paste it approximately in the center of the media using commercially available adhesive tape.

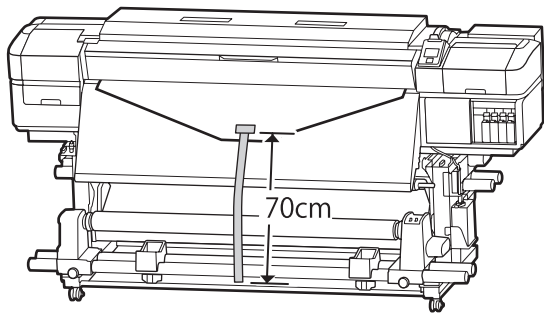

- 2 While pulling the paper tape straight down, wrap it around the roll core from front to back, and affix it using commercially available adhesive tape.

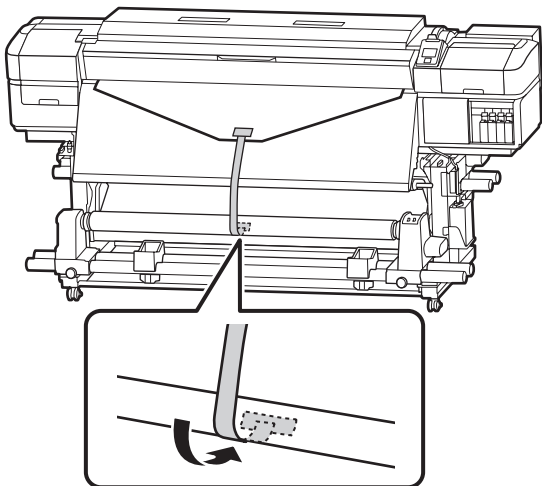

! **Important:**

Attach the paper tape to the take up roll core with the media in a taut state. If paper tape is attached in a loose state, the media may move around during take-up.

- 3 Flip the Auto switch to .

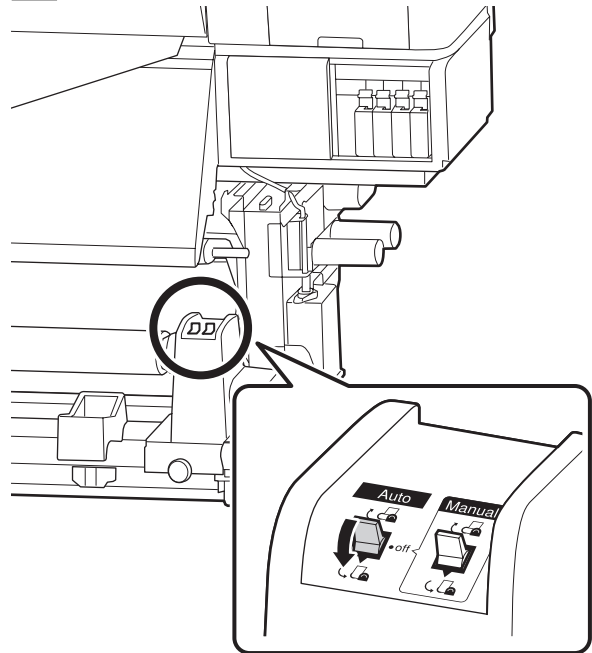

- 4 Lower the tension bar until it slightly touches the paper tape.

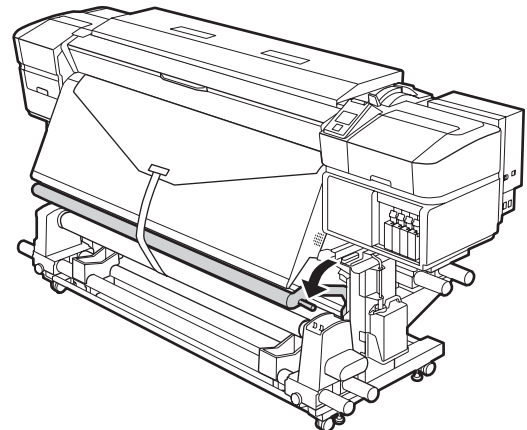

Basic Operations

Take-up with the Printed Side Facing In

- 1 Cut the paper tape approximately 70 cm in length, and paste it approximately in the center of the media using commercially available adhesive tape.

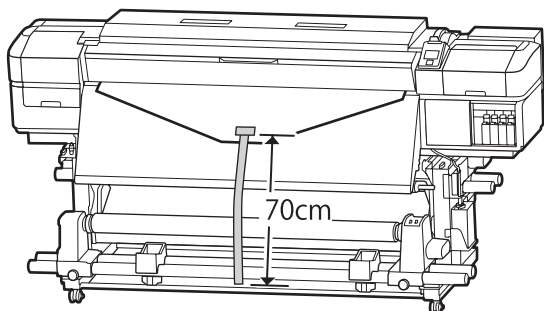

- 2 While pulling the paper tape straight down, wrap it around the roll core from back to front, and affix it using commercially available adhesive tape.

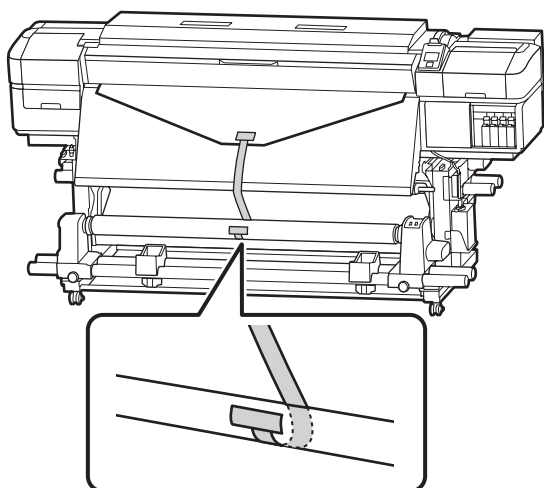

! **Important:**

Attach the paper tape to the take up roll core with the media in a taut state. If paper tape is attached in a loose state, the media may move around during take-up.

- 3 Flip the Auto switch to  .

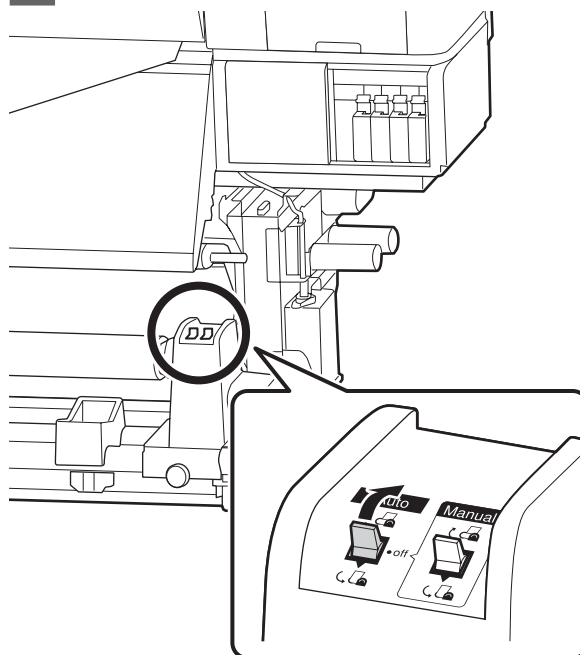

- 4 Lower the tension bar until it slightly touches the paper tape.

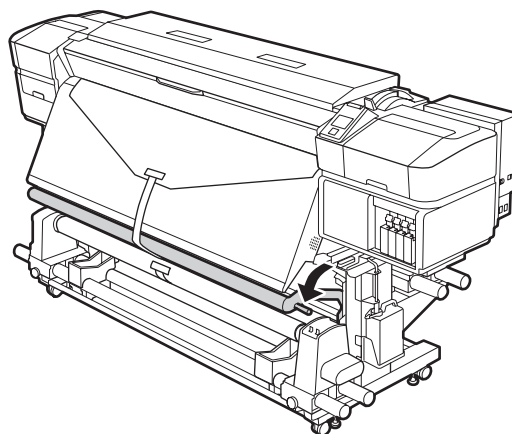

Settings for Loaded Media

When you have finished loading the media, follow the instructions on the control panel to make settings for the loaded media.

1. Select the media setting number

Select the media setting number to which the print settings have been registered.



Basic Operations

2. Select the roll winding specifications

Select the roll type for the loaded media roll.



3. Set the media length

Set the length of the loaded media.

Buttons that are used in the following settings

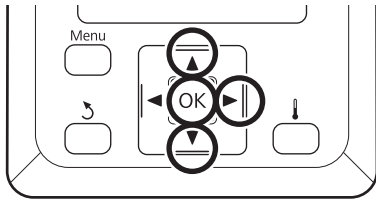

- 1 Use the ▼/▲ buttons to select the media setting number to which the print settings have been registered, and then press the OK button.

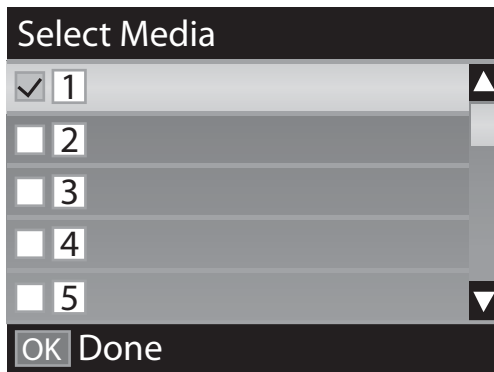

If media settings have not yet been made for new media, select an unassigned number, finish loading the media, and then perform Easy Media Setup.

Making Media Settings [User's Guide \(Online Manual\)](#)

- 2 Use the ▼/▲ buttons to select the roll type that matches the loaded roll, and then press the OK button.

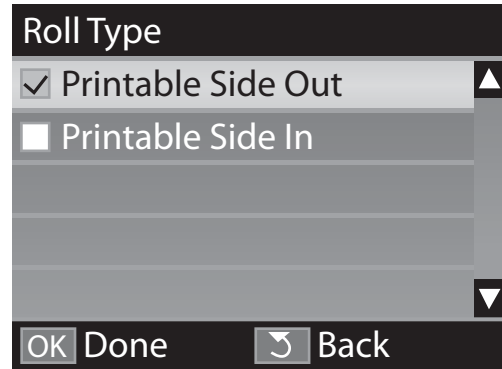

- 3 The screen where you can enter the length of the loaded media is displayed.

Use the ▼/▲ buttons to choose a length between 1.0 and 100.0 m and press the OK button.

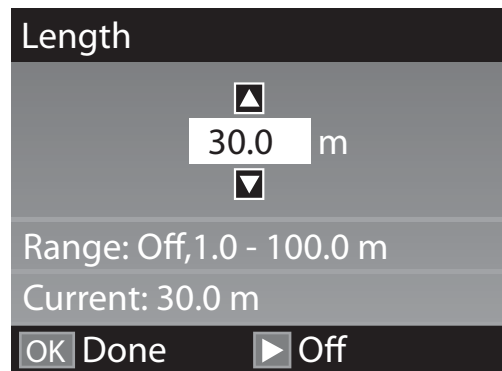

Set the value when remaining amount of media is printed on the roll.

Press the ► button if you want to select **OFF**. If you select **OFF**, the remaining amount is not calculated.

Note:

Two functions are enabled in Remaining Setup - ON

The following two functions give you a rough idea of the amount of media available before printing, making it easier to know when media requires replacement.

- ❑ **Showing Amount of Media Remaining**
The control panel display shows the approximate amount of media remaining based on the length set for the media and the amount used during printing.
- ❑ **Remaining Alert**
A warning is displayed when the amount of media remaining reaches a specified level.

Basic Operations

The printer will display **Ready** after a brief pause, showing that it is ready to print. Transmit the data to be printed from the computer.

Removing the Take-up Roll

Follow the steps below when replacing the media.

1. Print the remaining amount of media. (When Media Remaining is set to ON)



2. Cut the media.



3. Remove the media.

Printing the Amount of Media Remaining

By printing the remaining amount on the media being removed, you can check this value the next time the media is loaded and enter the media length. This is useful for accurate management of the amount of media remaining. The remaining amount cannot be printed when **Remaining Setup** is set to **OFF**.

The following section describes how to print the amount of media remaining.

Buttons that are used in the following settings

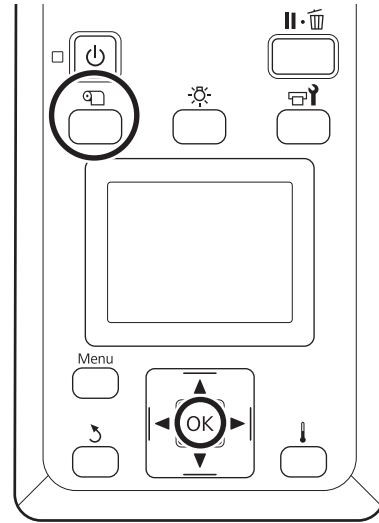

- 1** Confirm that the printer is ready to print.
- 2** Press the  button, select **Media Remaining**, and then press the OK button.
- 3** Select **Print Remaining Length** and press the OK button.
- 4** Press the OK button to print the amount of media remaining.

Cutting Media

 **Caution:**

- The heaters and media edge plate may be hot; observe all necessary precautions. Failure to observe the necessary precautions could result in burns.*
- When cutting media, be careful not to cut your fingers or hands with the cutter or other blades.*

Basic Operations

- 1 Press the  button, select **Feed To Cut Position**, and then press the OK button.

The trailing edge of the print is fed to the cut position (cutter groove).

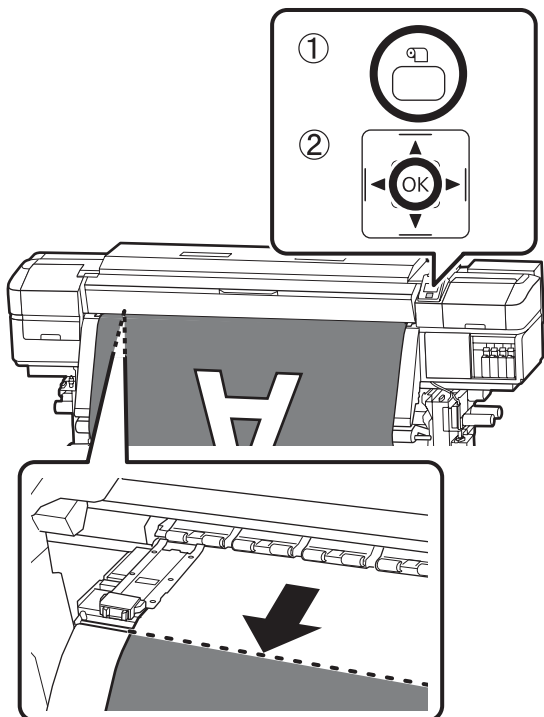

If you have printed the amount of media remaining, press the ▲ button to rewind the media so that this information will remain on the unprinted roll after the media is cut.

- 2 When using the Auto Take-up Reel Unit, raise the tension bar.

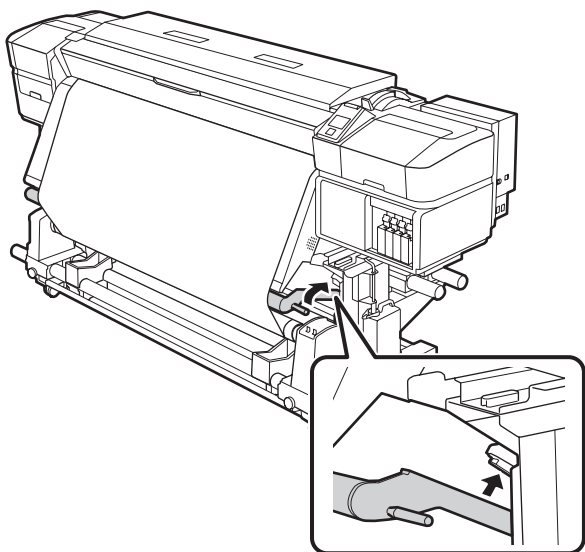

- 3 Hold the cutter vertically, and then move it so that the cutter blade fits closely to the side surface of the cutter groove.

When work cannot be performed properly, such as when your hand hits the front cover, open the front cover, and then cut.

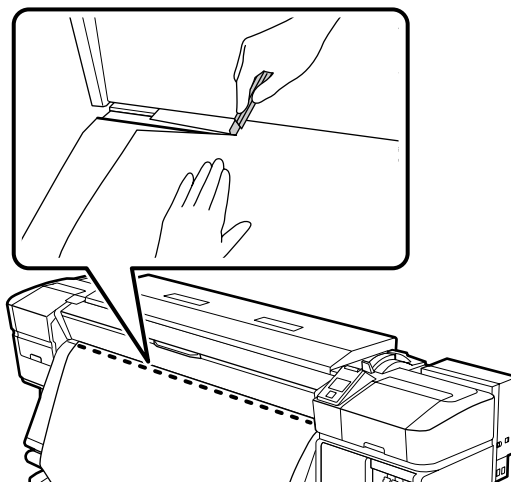

! **Important:**

When cutting the media, make sure the media has not risen up inside the front cover or come free from the media edge plate before proceeding to the next print.

- 4 Set the Auto switch to Off. Take up the cut media completely by operating the Manual switch according to how the media is rolled.

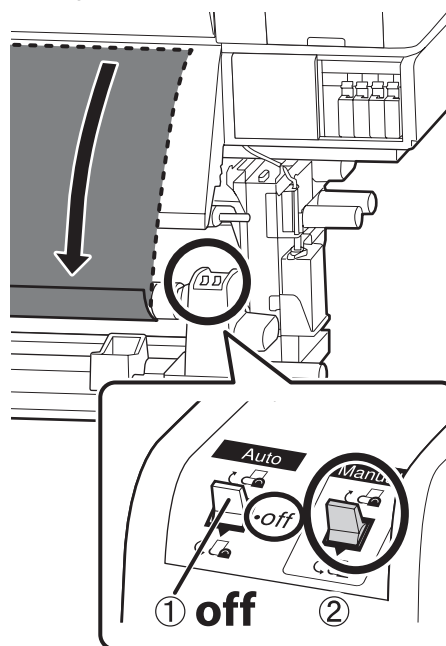

Basic Operations

Removing Media

Caution:

- ❑ If the media weighs over 20 kg, it should not be carried by one person. When loading or removing the media, use at least two people.
- ❑ Follow the instructions in the manual when loading media or roll cores or removing the take-up roll.
Dropping media, roll cores, or take-up rolls could result in injury.

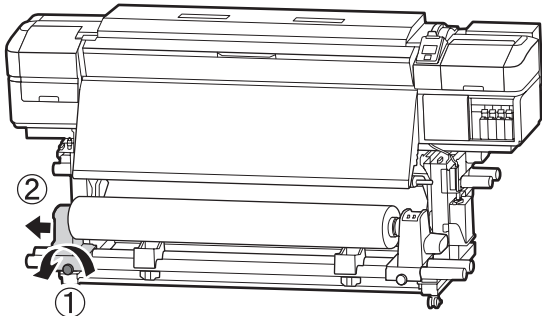
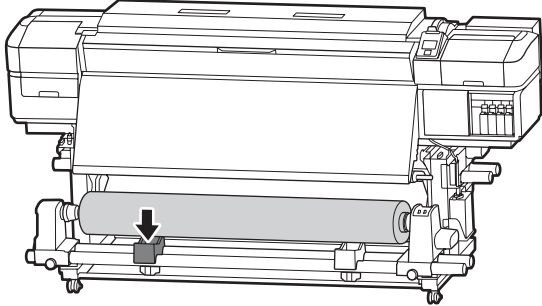
- 1 To prevent the take up roll from dropping, support the roll at its left end.
- 2 Loosen the left roll core holder screw and remove the roll core holder from the roll.
 
- 3 Lower the roll onto the roll support.
 
- 4 To prevent the take-up roll from dropping, support the roll at its right end.

- 5 Loosen the right roll core holder screw and remove the roll core holder from the roll.

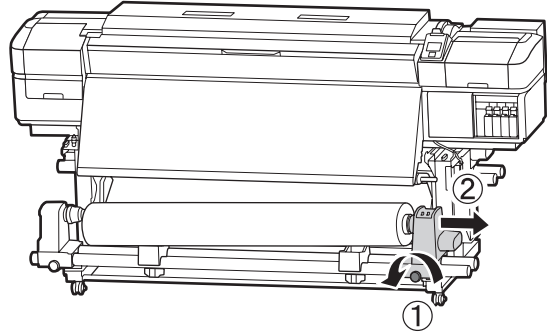

- 6 Lower the roll onto the roll support.

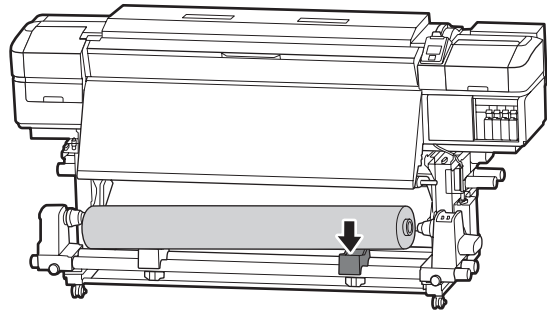

- 7 To remove media from the rear media feeding unit, reverse the steps you followed to load it.

Maintenance

Maintenance

When to Perform Various Maintenance Operations

Cleaning Locations and Cleaning Timing

If the printer continues to be used without being cleaned, nozzles clog or ink drops may occur.

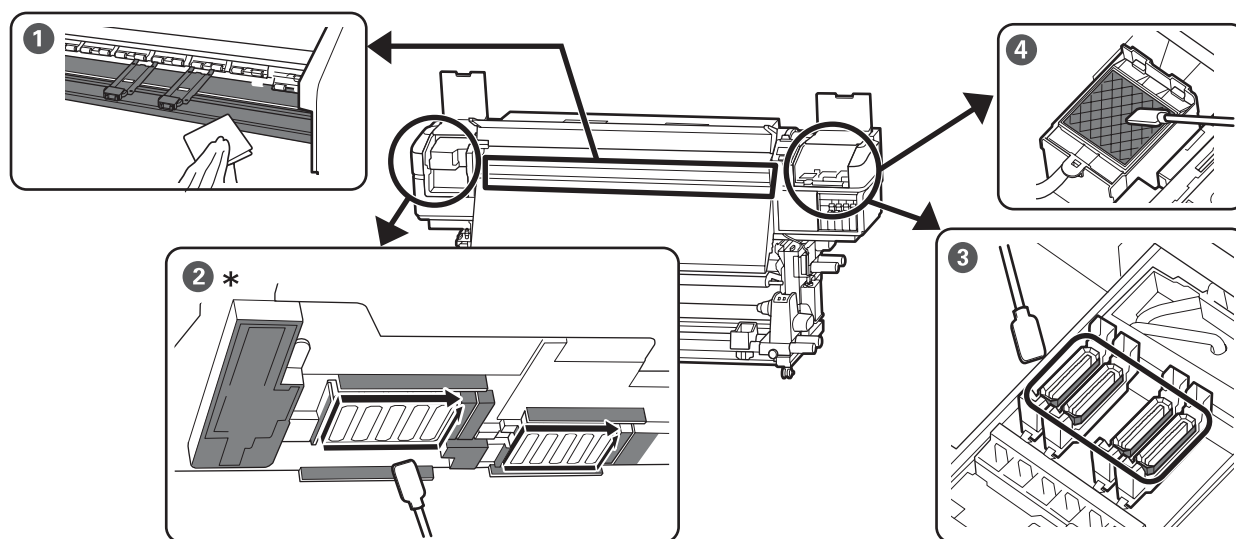

* Right print head only in SC-S40600 Series.

When to perform	Component to be cleaned
Before starting work every day	<p>① Platen heater and media edge plates</p> <p>☞ "Daily Cleaning" on page 27</p>
At least once a month	<p>② Around the Print Head</p> <p>③ Caps</p> <p>④ Flushing pad (when dirty)</p> <p>☞ "Performing Regular Cleaning" on page 28</p> <p>You can check the procedure in a video on YouTube.</p> <p>☞ "Video Manuals" on page 4</p>

! **Important:**

The printer contains precision instruments. If any lint or dust adheres to the nozzles on the print head, print quality will decline.

Perform regular cleaning more frequently depending on the environment and media being used.

Maintenance

Other Components to Be Cleaned





If you are concerned that components are getting dirty, clean the following components.

- Inside the front cover
- Pressure rollers

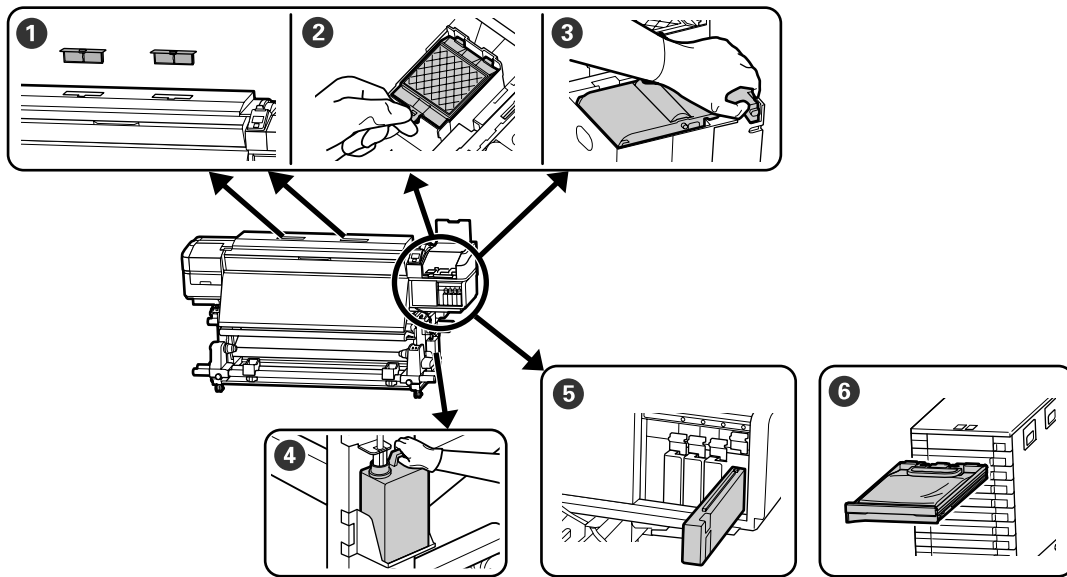
Cleaning  *User's Guide* (Online Manual)

Locations of Consumables and Replacement Timing



When to perform	Component to be replaced
When a prepare and replacement message is displayed on the control panel screen	<ul style="list-style-type: none"> ❶ Air filters ❷ Flushing pad ❸ Wiper unit <p> "Replacing Maintenance Parts" on page 42</p> <ul style="list-style-type: none"> ❹ Waste Ink Bottle <p> "Disposing of Waste Ink" on page 40</p>
When an error appears on the control panel screen indicating ink is expended	<ul style="list-style-type: none"> ❺ Ink cartridge (SC-S80600 Series/SC-S60600 Series/SC-S40600 Series) <p> "Replacement procedure" on page 35</p> <ul style="list-style-type: none"> ❻ Ink Supply Unit (SC-S80600L Series/SC-S60600L Series) <p> "Replacement procedure" on page 38</p>

Maintenance

Other maintenance

When to perform	Operation
When using SC-S80600 Series/SC-S60600 Series/SC-S40600 Series <ul style="list-style-type: none"> <input type="checkbox"/> Once every three weeks <input type="checkbox"/> Before the start of daily print work (WH/MS only)*1 	Shaking ink cartridges 🔗 "Shaking" on page 35
When using SC-S80600L Series/SC-S60600L Series <ul style="list-style-type: none"> <input type="checkbox"/> When LED lamp on ink unit flashes blue (once every three weeks) <input type="checkbox"/> Before the start of daily print work (WH/MS only)*1 	Shaking Ink Supply Units 🔗 "Shaking" on page 37
<ul style="list-style-type: none"> <input type="checkbox"/> When checking if nozzles are clogged <input type="checkbox"/> When checking which colors are clogged <input type="checkbox"/> Horizontal stripes or tint unevenness (banding) are appeared 	Checking for clogged nozzles*2
When a clog is found after checking for clogged nozzles	Head Cleaning 🔗 "Head Cleaning" on page 57
When the printer will not be used for an extended period (and switched off)	Pre-Storage Maint. 🔗 "Long-term Storage (Pre-storage Maintenance)" on page 47
When a greasing message is displayed on the control panel	Applying the supplied grease to the carriage rod*2

*1 When 10 color mode is selected on SC-S80600 Series/SC-S80600L Series.

*2 Details [🔗 User's Guide \(Online Manual\)](#)

Maintenance

What You'll Need

Prepare the following items before beginning regular cleaning and consumable replacement.

When the supplied parts have been completely used, purchase new consumables.

Prepare dedicated parts for this printer when replacing ink cartridges/ink supply units or performing maintenance.

 ["Information on Maintenance Items" on page 49](#)

If your gloves have worn out, prepare commercially available nitrile gloves.

Protective eyewear (available in the market)

Protects your eyes from ink and ink cleaner.

Mask (available in the market)

Protects your nose and mouth from ink and ink cleaner.

Maintenance Kit (supplied with the printer)

For general cleaning.

The following items are in the kit.

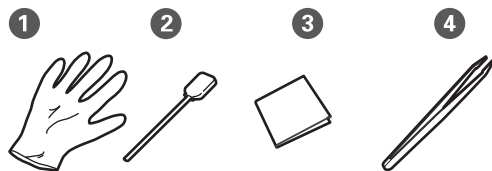

① Gloves (x12)

② Cleaning sticks (x20)

③ Clean-room wipers (x100)

④ Tweezers (x1)

Ink cleaner (supplied with the printer)

Use when wiping ink stains.

Usage method  ["Using Ink Cleaner" on page 28](#)

A metal tray (supplied with the printer)



Use when putting cleaning tools, removed consumables, or ink cleaner moved in the container supplied with the printer.

Important:

If the used cleaning stick, etc. are directly put on the printer, it may cause a deformation from the characteristics of the ink cleaner.

Precautions regarding maintenance

Note the following points when cleaning and replacing parts.

Caution:

Store ink cartridges, Cleaning Cartridge, ink cleaner, grease, and waste ink in a location out of reach of children.

During maintenance, wear protective clothing, including protective eyewear, gloves, and a mask.

Should ink, waste ink, ink cleaner, or grease contact your skin or enter your eyes or mouth, take the following actions:

If fluid adheres to your skin, immediately wash it off using large volumes of soapy water. Consult a physician if the skin appears irritated or is discolored.

If fluid enters your eyes, rinse immediately with water. Failure to observe this precaution could result in bloodshot eyes or mild inflammation. If problems persist, consult with a physician.

If fluid enters your mouth, consult a physician immediately.

If fluid is swallowed, do not force the person to vomit, and consult with a physician immediately. If the person is forced to vomit, fluid may get caught in the trachea which can be dangerous.

After replacing the Waste Ink Bottle or using the ink cleaner, wash your hands and gargle thoroughly.

Maintenance

- ❑ Remove the media from the printer before proceeding.
- ❑ Never touch the belts, circuit boards, or any parts that do not require cleaning. Failure to observe this precaution could result in malfunction or reduced print quality.
- ❑ Use only the supplied cleaning sticks or sticks contained in a maintenance kit. Other types of sticks that produce lint will damage the print head.
- ❑ Always use fresh cleaning sticks. Re-using sticks can make stains even harder to remove.
- ❑ Do not touch the tips of the cleaning sticks. Oil from your hands could damage the print head.
- ❑ Do not use water or alcohol to clean around the print head or the caps. Ink congeals when mixed with water or alcohol.
- ❑ Touch a metallic object before starting work to discharge any static electricity.

Daily Cleaning

When lint, dust, or ink adheres to the platen heater or the media edge plates, it could cause clogged nozzles or ink drops to occur.

To maintain optimum printing quality, we recommend cleaning before starting work every day.

⚠ Caution:

- ❑ *The heaters and media edge plate may be hot; observe all necessary precautions. Failure to observe the necessary precautions could result in burns.*
- ❑ *Be careful not to trap your hands or fingers when opening or closing the front cover. Failure to observe this precaution could result in injury.*

⚠ Important:

Do not use ink cleaner to clean inside the printer. Otherwise, parts inside the printer could be damaged.

- 1** Turn off the printer, wait until the screen display disappears, and then unplug the power cable from the electrical outlet.

Disconnect both of the power cables.

If the additional print drying system is installed, make sure you unplug the power cable for the additional print drying system as well.

- 2** Wait for approximately one minute after unplugging the power cables.

- 3** Open the front cover.

- 4** Soak a soft cloth in water, wring it out thoroughly, and then wipe off any ink, lint, or dust that has adhered to the platen heater.

Make sure you remove any lint or dust that has settled in the grooves on the platen.

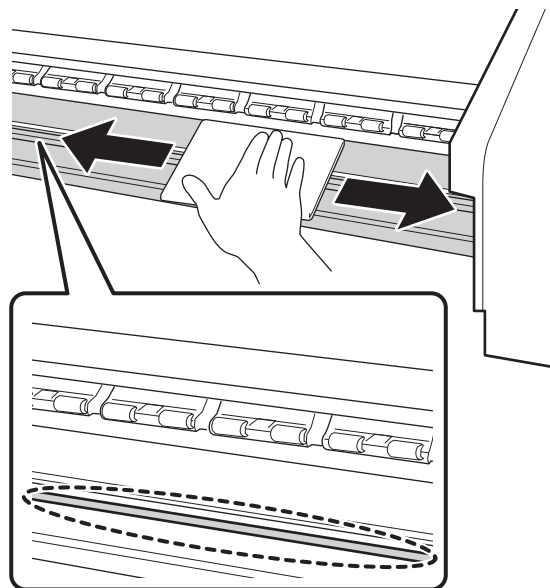

- 5** Soak a soft cloth in water, wring it out thoroughly, and then wipe off any lint, or dust that has adhered to the media edge plates.

⚠ Important:

If you are using media with glue, soak the cloth in a diluted detergent, wring it out thoroughly, and then wipe the areas. If you continue printing while glue is stuck to the rear, it may rub against the print head.

Maintenance

When using media with glue and when ink adheres

Remove the media edge plates from the printer, and clean the front and back of the plates.

After cleaning, re-install the plates as they were.

Removing and installing the media edge plates

 [User's Guide](#) (online manual)

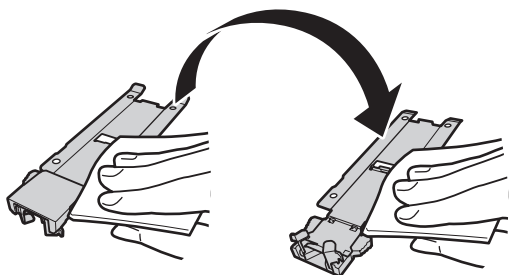

Performing Regular Cleaning

When the following message is displayed on the control panel, perform regular cleaning as soon as possible.

Press  and perform Head Maintenance.

Clean the parts in the following order.

Moving the Print Head



Cleaning Around the Print Head



Cleaning Around the Caps

Using Ink Cleaner

Only use ink cleaner to clean the parts indicated in the manual. Using ink cleaner on other parts of the printer could damage the product.

Before starting this procedure, be sure to read the following:

 ["Precautions regarding maintenance" on page 26](#)

- 1 Put the cup supplied with the ink cleaner on the metal tray, and pour approximately 10 ml of ink cleaner into the cup.

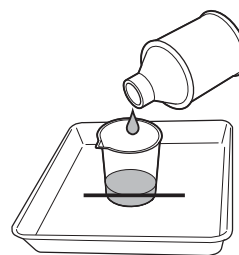

- 2 Dampen the cleaning stick with ink cleaner. Do not allow ink cleaner to drip from the cleaning stick.

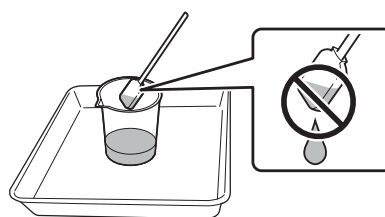

When dampening a clean-room wiper with ink cleaner, use ink cleaner poured into a cup.

Important:

- Do not reuse ink cleaner. Using dirty ink cleaner will make staining worse.
- Used ink cleaner, cleaning stick, and clean-room wipers are industrial waste. Dispose of them in the same way as for waste inks.
 ["Disposal of used consumables" on page 45](#)
- Store ink cleaner at room temperature out of direct sunlight.
- After using the ink cleaner, be sure to first close the inner cap and then the outer cap. Failure to securely close these caps may cause a leakage or volatilization of the ink cleaner.

Moving the Print Head

This section describes how to move to cleaning position of the print head.

Maintenance

! **Important:**

Be sure to follow the steps below when positioning the print head. Moving the print head manually could cause malfunction.

Buttons that are used in the following settings

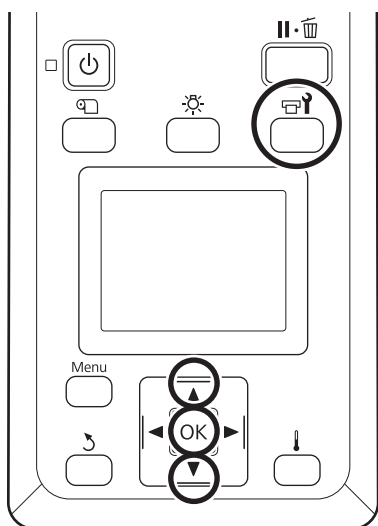

- 1** Confirm that the printer is on and press the button.
The Maintenance menu will be displayed.
- 2** Use the / buttons to select **Head Maintenance** and press the OK button.
- 3** Use the / buttons to select **Regular Cleaning**, and then press the OK button.
The print head moves to the cleaning position.

Note:

The buzzer sounds 10 minutes after the print head is moved (default setting). Press the OK button to continue the cleaning process. After 10 more minutes have passed, the buzzer sounds again.

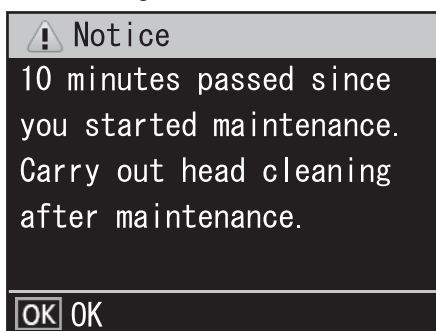

Cleaning Around the Print Head

If you notice any ink clots, lint, or dust when checking the area around the print head, clean the area by following the steps below.

The SC-S80600 Series/SC-S80600L Series/SC-S60600 Series/SC-S60600L Series have two print heads. Clean around both print heads.

Before starting this procedure, be sure to read the following:

[“Precautions regarding maintenance” on page 26](#)

- 1** After the print head moves to the left end of the printer, open the left maintenance cover.

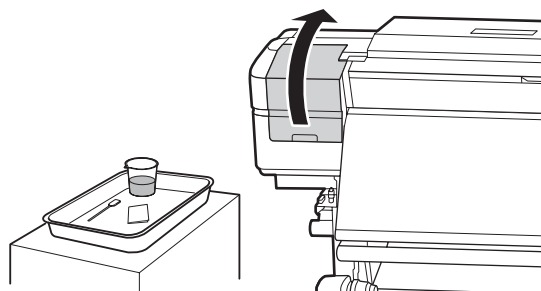

- 2** Dampen the cleaning stick with ink cleaner. Use new cleaning stick and ink cleaner.

[“Using Ink Cleaner” on page 28](#)

! **Important:**

- Rinse a cleaning stick using ink cleaner for each step.
- After removing a clot of ink with a cleaning stick, wipe off using a clean-room wiper.

Maintenance

- 3** Wipe off any adhered ink, lint, and dust from the parts that are indicated by the arrows below.

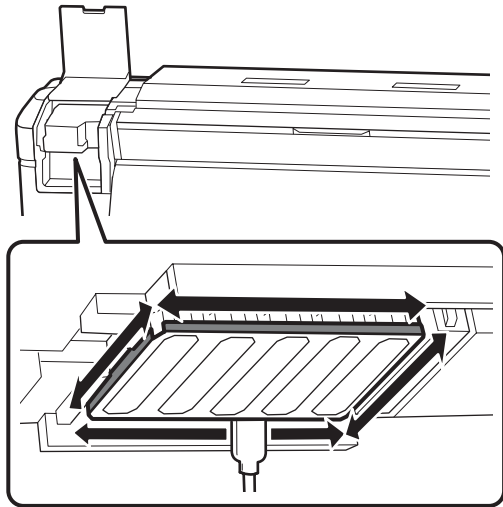

- 4** Wipe off any adhered ink, lint, and dust from the parts that are indicated by  below.

Right print head only in SC-S40600 Series.

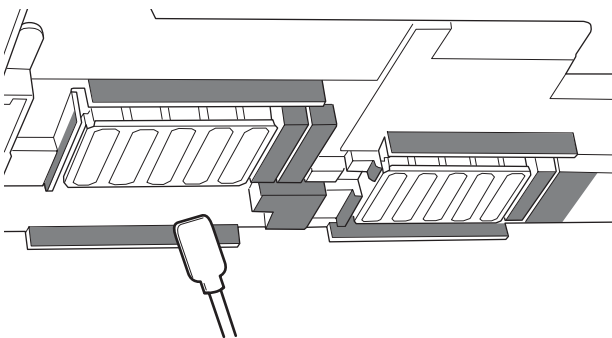

- 5** Wipe off any adhered ink, lint, and dust from the parts that are indicated by  below.

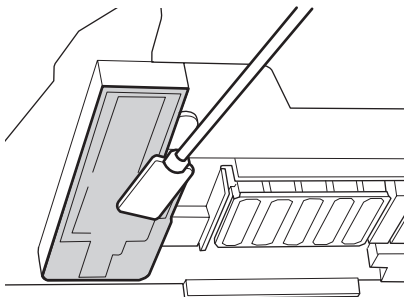

- 6** Close the left maintenance cover.

 [“Precautions regarding maintenance” on page 26](#)

Cleaning Caps

- 1** Open the right maintenance cover.

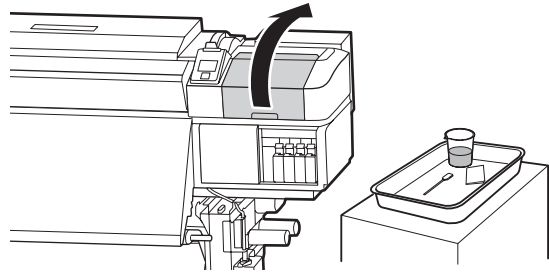

- 2** Dampen the cleaning stick with ink cleaner.

 [“Using Ink Cleaner” on page 28](#)

- 3** Hold the cleaning stick flat and wipe the edges of all the caps.

The SC-S80600 Series/SC-S80600L Series/SC-S60600 Series/SC-S60600L Series have two blocks of caps. Clean all of the caps.

Cleaning Around the Caps

Before starting this procedure, be sure to read the following:

Maintenance

! Important:

Do not push strongly against the edges or the surrounding area of the cap, or touch the inner side of the cap with a cleaning stick or tweezers. The part maybe deformed, and it may no longer be possible to perform capping correctly.

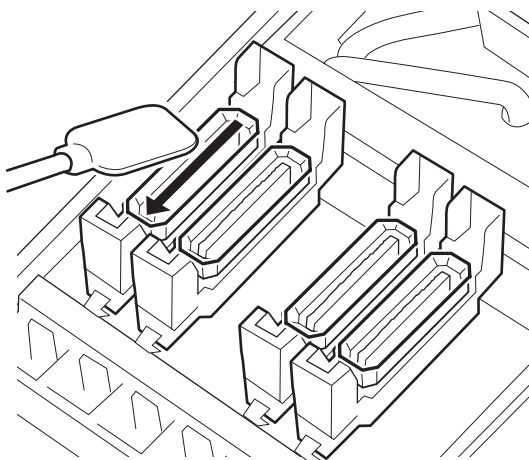
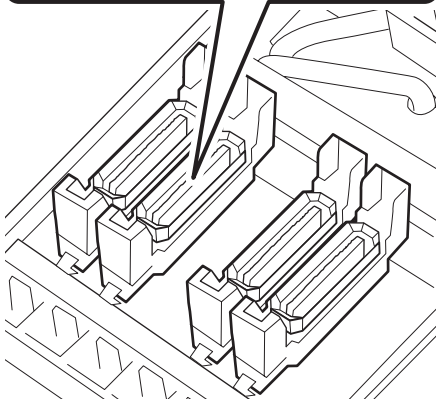
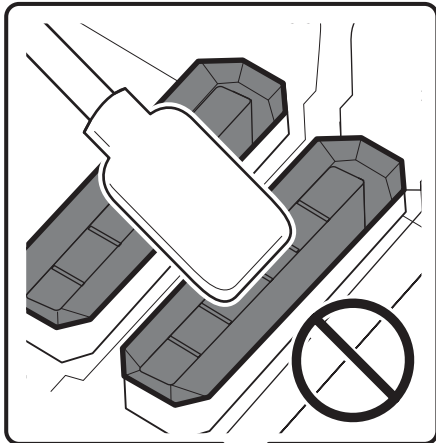

4

Hold the cleaning stick in a perpendicular orientation, and wipe the outer areas of all the caps.

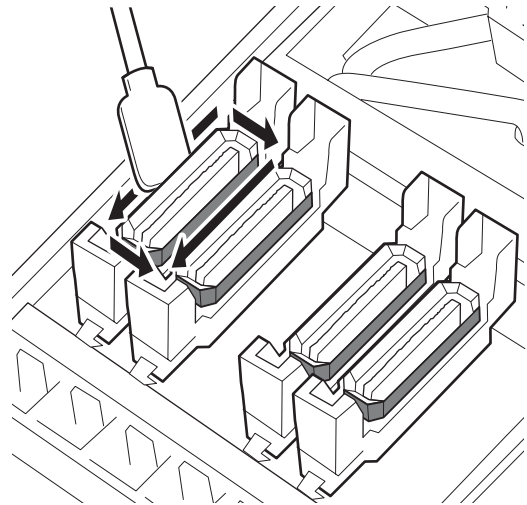

Points to note when cleaning caps

Check the following points when cleaning the caps.

- Has ink adhered to the guide section in front of and behind the cap?

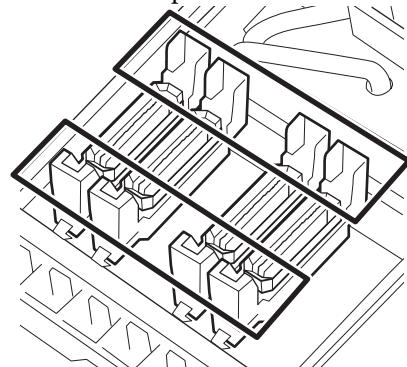

- Has a film of ink adhered to the guide section?
- Is there any lint attached to the inside of the cap?
- Is there any lint attached to the flushing pad?

If they do not require cleaning, the procedure is complete.

 [“Finishing Cleaning” on page 33](#)

If they require cleaning, see the following sections and perform the necessary cleaning.

Maintenance

When ink adheres to the guide section

- 1** Dampen the cleaning stick with ink cleaner.
 [“Using Ink Cleaner” on page 28](#)
- 2** Apply ink cleaner to the guide section, and then wipe it down.

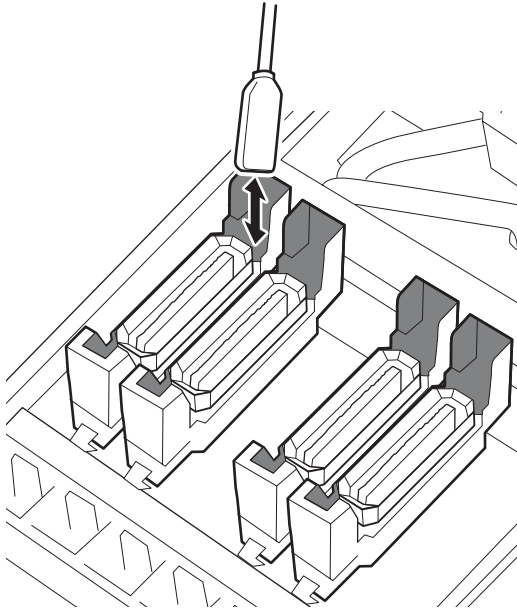

If no other parts need to be cleaned, proceed to the following section.

 [“Finishing Cleaning” on page 33](#)

When a film of ink adheres to the guide section

If a film-like layer of adhered ink cannot be removed completely using a cleaning stick, remove it using tweezers.

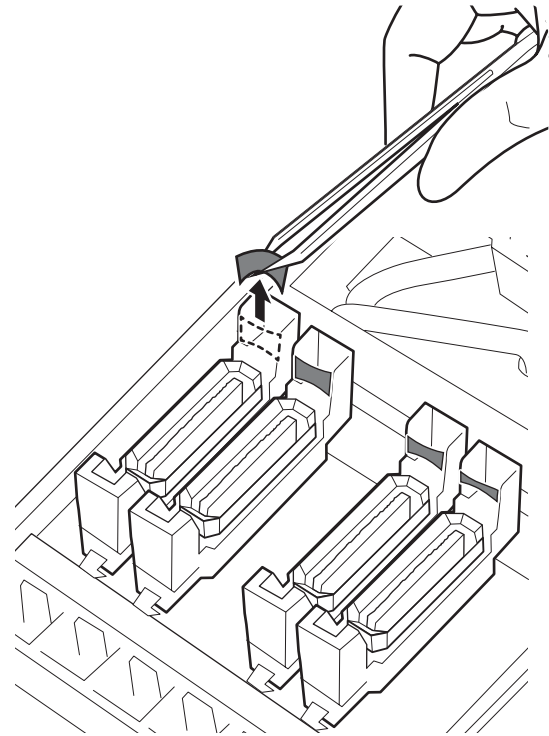

If no other parts need to be cleaned, proceed to the following section.

 [“Finishing Cleaning” on page 33](#)

Maintenance

When there is lint or dust in the cap

Remove using the tip of the cleaning stick or tweezers.

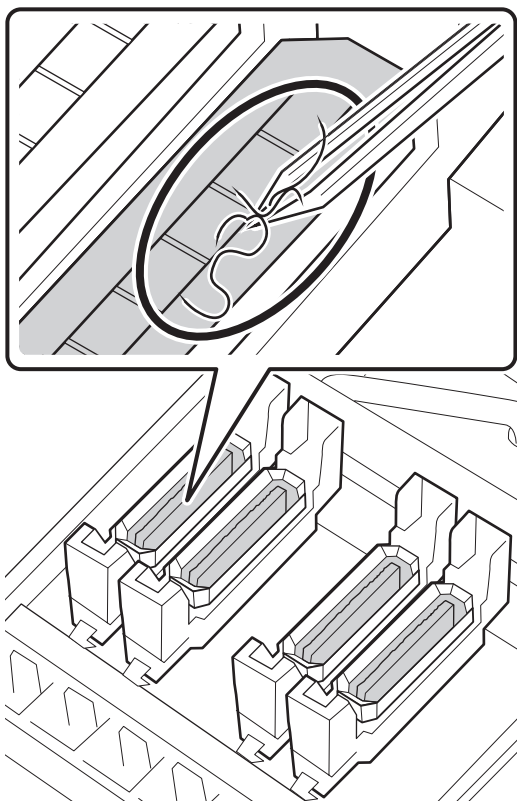

If no other parts need to be cleaned, proceed to the following section.

 [“Finishing Cleaning” on page 33](#)

When there is lint attached to the flushing pad

Wipe off lint and dust with the tip of a cleaning stick.

 **Important:**

Do not deform the metal section of the top surface. If they are deformed, they may damage the print head.

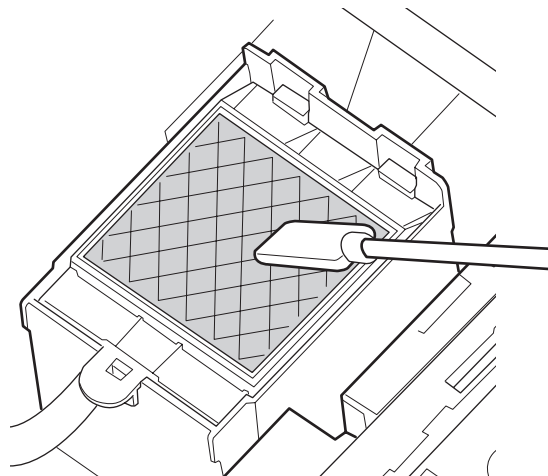

If no other parts need to be cleaned, proceed to the following section.

 [“Finishing Cleaning” on page 33](#)

Finishing Cleaning

After cleaning, close the right maintenance cover and press the OK button.

The menus will close when the print head returns to its normal position.

To make prints followed by the cleaning, perform Nozzle Check.

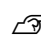
 [User's Guide \(Online Manual\)](#)

Disposing of used ink cleaner, cleaning stick, and clean-room wipers  [“Disposal of used consumables” on page 45](#)

Maintenance

Cleaning Check Sheet

Copy this page to track maintenance tasks.

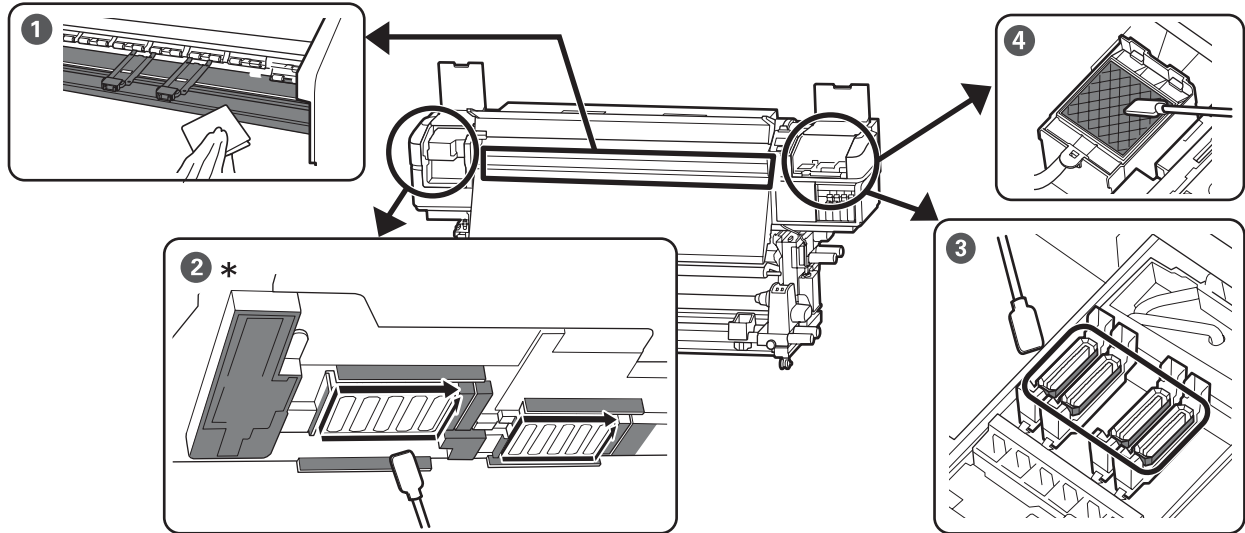

* Right print head only in SC-S40600 Series.

When to perform	Component to be cleaned	Cleaned on date				
Before starting work every day	1 Platen heater and media edge plates ⓘ "Daily Cleaning" on page 27	/	/	/	/	/
		/	/	/	/	/
		/	/	/	/	/
		/	/	/	/	/
		/	/	/	/	/
At least once a month	2 * Around the Print Head 3 Around caps 4 Flushing pad ⓘ "Performing Regular Cleaning" on page 28	/	/	/	/	/
		/	/	/	/	/
		/	/	/	/	/
		/	/	/	/	/
When dirty*	Front cover	/	/	/	/	/
	Pressure rollers	/	/	/	/	/

* Cleaning ⓘ *User's Guide* (Online Manual)

Maintenance

Shaking and Replacing Ink Cartridges (SC-S80600 Series/SC-S60600 Series/SC-S40600 Series)

Shaking

Shaking timing and count

! Important:

Due to ink characteristics, the ink cartridges of this printer are prone to sedimentation (components settling to the bottom of the liquid). If ink settles, tint unevenness and nozzle clogs occur.

Shake a new ink cartridge before installing it. After installing it in the printer, remove and shake it periodically.

- When replacing Remove it from the bag and then shake it. The number of shakes depends on the ink color.

OR, WH, MS	Approx. 50 times in 15 seconds
Colors other than OR, WH, MS	Approx. 15 times in 5 seconds

- Before the start of daily print work (WH/MS only) WH and MS tend to settle more than other colors. Before the start of daily print work, remove the ink cartridge, and then shake it the number of times listed below.

Approx. 15 times in 5 seconds

If a cartridge has not been shaken for 24 hours or more, the following message appears. If the message appears, remove the ink cartridge immediately, and then shake it.

Remove and shake (MS/WH) ink cartridge(s).

- Once every three weeks (each color excluding WH/MS) Even after installing an ink cartridge in the printer, remove and shake it periodically.

Approx. 15 times in 5 seconds

Shaking method

- Make sure the printer is on, and then remove the ink cartridge.
When replacing a cartridge, remove the new one from the bag.
- Hold the cartridge horizontally and shake it in both directions about 5 cm approx. 15 times in 5 seconds.
In the case of OR, WH, or MS, shake it well approx. 50 times in 15 seconds during replacement only.

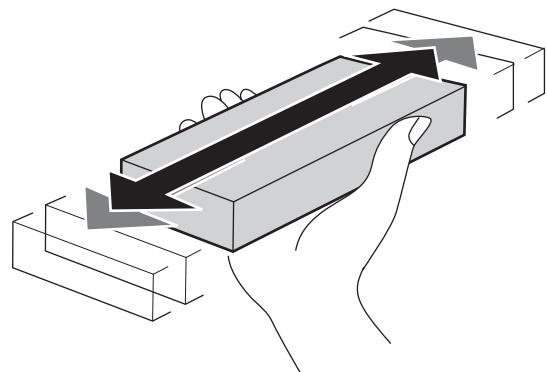

Replacement procedure

If one of the installed ink cartridges is expended, printing cannot be performed.

! Important:

When the message **⊗ Ink Cartridge Expended** appears with use of WH/MS ink, replace the cartridge with a new one immediately.

If the printer is left with the ink remaining alert displayed, a print head or other part may be damaged.

If an ink cartridge is expended while printing, you can continue printing after replacing the ink cartridge. If you continue to use ink cartridges that are running low, you may need to replace the ink cartridge while printing. If you replace the ink cartridge while printing, colors may look different depending on how the ink dries. If you want to avoid issues such as this, we recommend replacing the cartridge before printing. You can still use the removed ink cartridge in the future until the ink cartridge is expended.

Maintenance

The following procedure explains how to replace an ink cartridge and a cleaning cartridge.

! Important:

Epson recommends the use of genuine Epson ink cartridges. Epson cannot guarantee the quality or reliability of non-genuine ink. The use of non-genuine ink may cause damage that is not covered by Epson's warranties, and under certain circumstances, may cause erratic printer behavior. Information about non-genuine ink levels may not be displayed, and use of non-genuine ink is recorded for possible use in service support.

- 1 Make sure the printer is on.
- 2 Lift the lock lever for the cartridge you intend to replace.

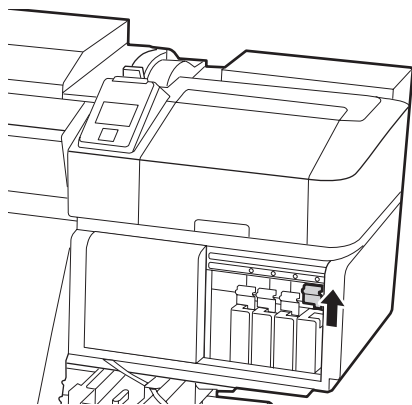

- 3 Insert a finger into the depression on the top of the cartridge and pull the cartridge straight toward you.

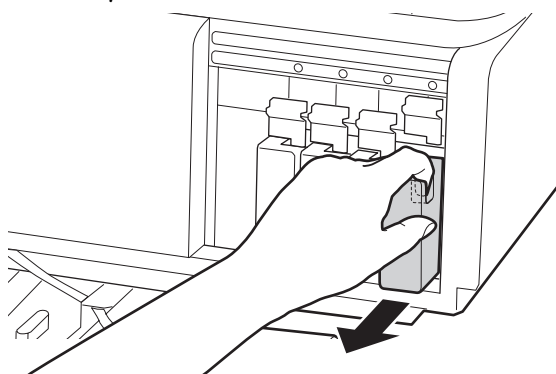

! Important:

Removed ink cartridges may have ink around the ink supply port, so be careful not to get any ink on the surrounding area when removing the cartridges.

- 4 Hold the cartridge horizontally and shake it in both directions about 5 cm approx. 15 times in 5 seconds.

In the case of OR, WH, or MS, shake it well approx. 50 times in 15 seconds.

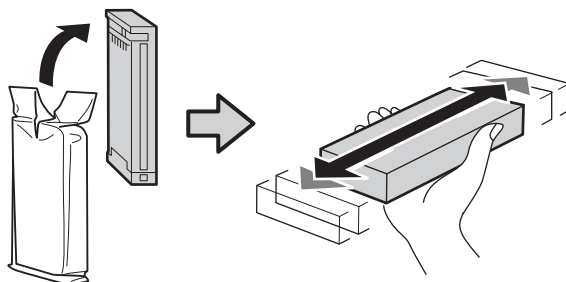

- 5 Match the color of the cartridge to the color of the label on the printer and insert.

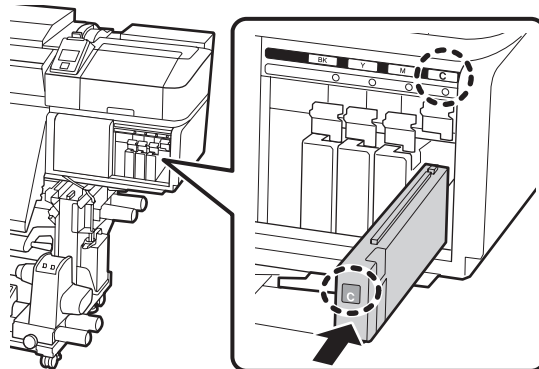

- 6 Lower the lock lever to engage the latch.

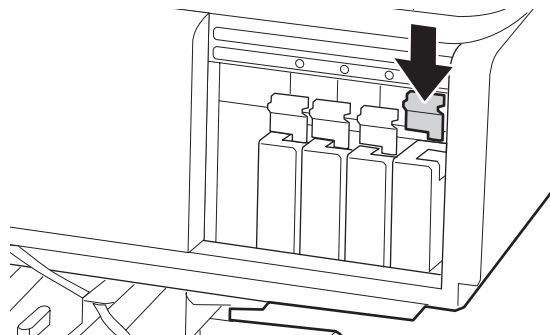

Repeat Steps 2 to 6 to replace other ink cartridges.

Maintenance

 **Important:**
 Install all ink cartridges into each slot. You cannot print if any of the slots are empty.

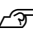
Disposal  "Disposal of used consumables" on page 45

Shaking and Replacing Ink Supply Units (SC-S80600L Series/SC-S60600L Series)

Shaking

Timing and frequency of shaking

 **Important:**
 Due to ink characteristics, the ink supply units of this printer are prone to sedimentation (components settling to the bottom of the liquid). If ink settles, tint unevenness and nozzle clogs occur.
 Shake a new ink supply unit before installing it. After installing it in the ink unit, remove and shake it periodically.

- When replacing
 The number of shakes depends on the ink color.

OR, WH, MS	Approx. 25 times in 25 seconds
Colors other than OR, WH, MS	Approx. 5 times in 5 seconds

- Before the start of daily print work (WH/MS only)
 WH and MS tend to settle more than other colors. Before the start of daily print work, remove the ink supply units, and then shake them the number of times listed below.

Approx. 5 times in 5 seconds

If they are not shaken for 24 hours or more, the following message appears. If the message appears, remove the tray immediately, and then shake it.
Remove and shake (MS/WH) ink supply unit(s).

- Once every three weeks (each color excluding WH/MS)
 Remove any tray whose LED lamp is flashing blue, and then shake the tray. To maintain print quality, do not continue using them when they are flashing blue.

Approx. 5 times in 5 seconds

Maintenance

Shaking method

- 1 Make sure the printer is on, and then pull the tray that needs to be shaken out of the ink unit.

Any ink supply unit whose LED lamp is flashing blue needs to be shaken.

! **Important:**

Place your hand on the bottom of the tray while removing it. If you use only one hand, the weight of the tray may cause it to fall, and be damaged, as you remove it.

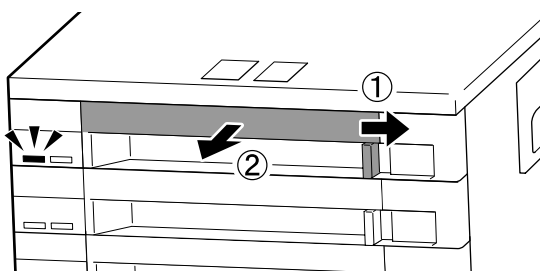

Note:

While the tray is pulled out, check the ink supply ports of the ink supply units. If ink has dripped from the port as shown in the photo or accumulated below, wipe it off using a cleaning stick.

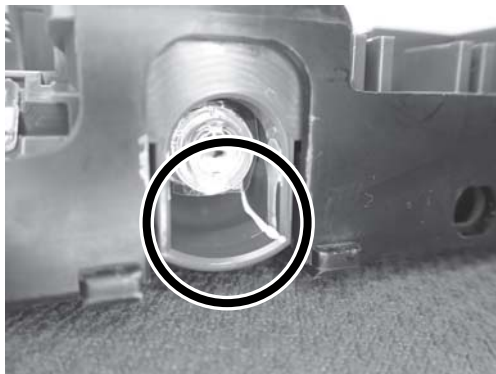

Do not touch the ink supply ports while wiping.

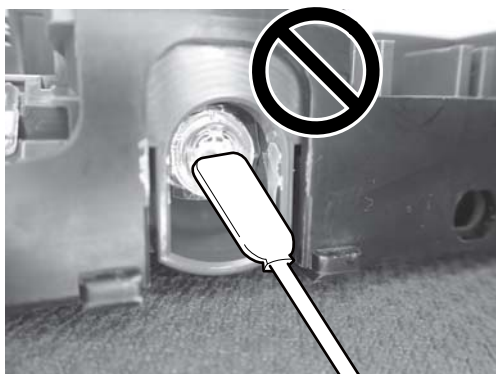

- 2 While the ink supply unit is in the tray, as shown in the illustration below, carefully shake it by tilting it up and down at about a 60 degree angle 5 times in 5 seconds.

In the case of OR, WH, or MS, shake it well approx. 25 times in 25 seconds during replacement only.

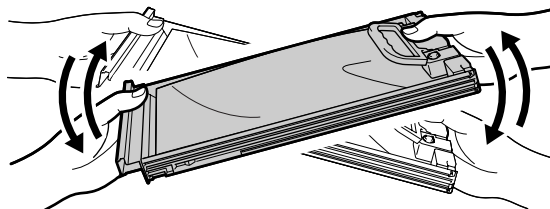

! **Important:**

Do not forcefully shake or swing ink supply units or trays holding an ink supply unit. Ink could leak.



Replacement procedure

If one of the installed ink supply units is expended, printing cannot be performed.

! **Important:**

When using WH/MS ink, immediately replace the ink supply unit with a new one if **✕ Ink Expended** appears.

If the printer is left with the ink remaining alert displayed, a print head or other part may be damaged.

Maintenance

If ink is expended while printing, you can continue printing after replacing the ink supply unit. If you continue to use an ink supply unit that is running low, you may need to replace the ink supply unit while printing. If you replace it while printing, colors may look different depending on how the ink dries. If you want to avoid issues such as this, we recommend replacing the supply unit before printing. You can still use the removed ink supply unit in the future until the ink supply unit is expended.

The following procedure explains how to replace ink supply units and cleaning ink supply unit.

! **Important:**

Epson recommends the use of genuine Epson ink supply units. Epson cannot guarantee the quality or reliability of non-genuine ink. The use of non-genuine ink may cause damage that is not covered by Epson's warranties, and under certain circumstances, may cause erratic printer behavior. Information about non-genuine ink levels may not be displayed, and use of non-genuine ink is recorded for possible use in service support.

1 Make sure the printer is on.

2 Pull the tray of the ink supply unit you want to replace out of the ink unit.

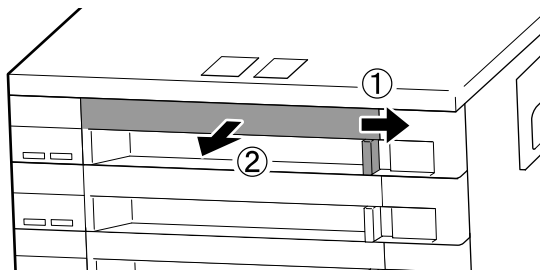

3 Remove the ink supply unit from the tray.

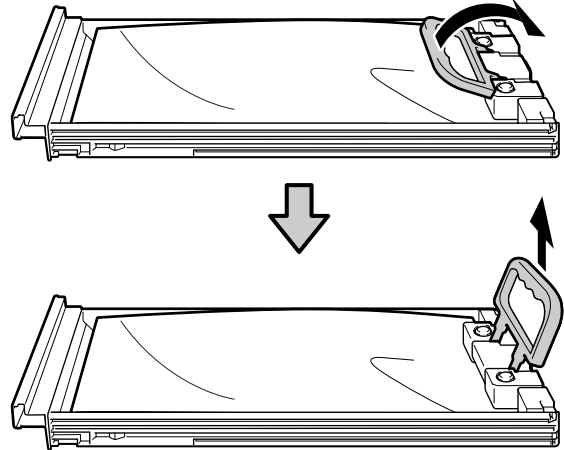

! **Important:**

Removed ink supply units may have ink around the ink supply port, so be careful not to get any ink on the surrounding area when removing the ink supply units.

4 Place the new ink supply unit into the tray and lower the handle.

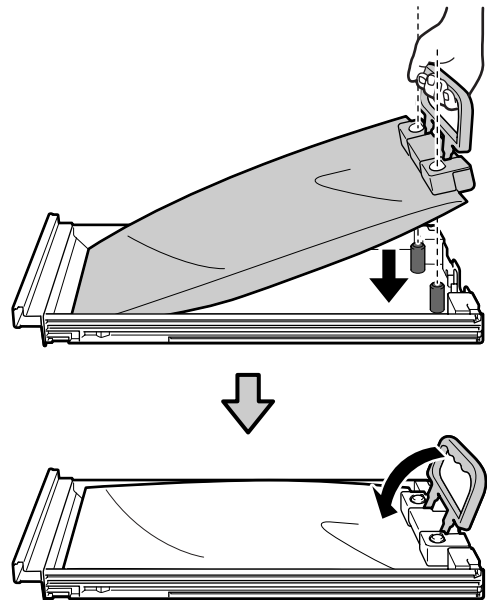

Maintenance

5 While the ink supply unit is in the tray, as shown in the illustration below, carefully shake it by tilting it up and down at about a 60 degree angle 5 times in 5 seconds.

In the case of OR, WH, or MS, shake it well approx. 25 times in 25 seconds.

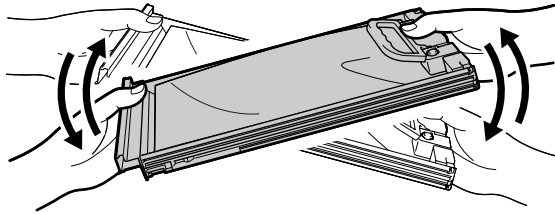

6 Match the color on the label on the ink supply unit with the label on the ink unit, and then fully insert the tray.

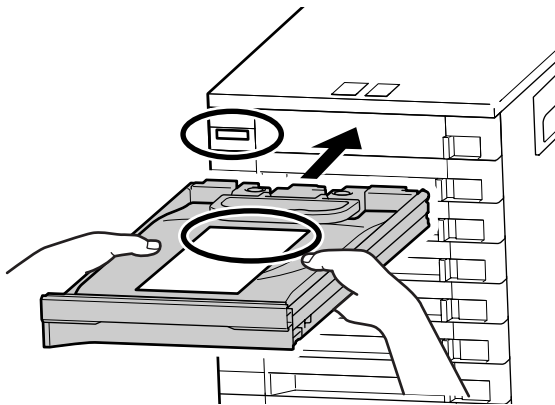

7 Move the lock switch to the left to lock it.

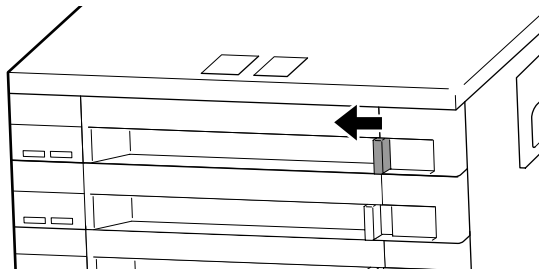

Repeat steps 2 to 7 to replace other ink supply units.

Important:

Place ink supply units in all the trays, and then insert them into the ink unit. Printing is not possible if, for even one color, an ink supply unit is not loaded into a tray or a tray is not inserted into the ink unit.

Disposal [“Disposal” on page 45](#)

Disposing of Waste Ink

Preparing and Replacement Timing

When Prepare empty waste ink bottle. is displayed
Prepare a new waste ink bottle as soon as possible.

When you want to replace the waste ink bottle at this stage due to night operations and so on, select **Replace Ink Bottle** from the setup menu, and then replace the bottle. If you perform the replacement without selecting **Replace Ink Bottle**, the waste ink counter will not operate correctly.

Details on the setup menu [User's Guide \(Online Manual\)](#)

Waste Ink Counter [“Waste Ink Counter” on page 40](#)

Important:

During printing or while the printer is running the operations shown below, do not remove the Waste Ink Bottle unless instructed to do so by the on-screen instructions. Failure to observe this precaution could cause ink to leak.

- Head Cleaning
- Head Washing
- Ink Refresh
- Pre-Storage Maint.

When Replace waste ink bottle and press OK. is displayed

Replace the waste ink bottle with a new bottle immediately.

Replacement procedure [“Replacing the Waste Ink Bottle” on page 41](#)

Waste Ink Counter

The printer uses the waste ink counter to track waste ink and displays a message when the counter reaches the warning level. If you replace the Waste Ink Bottle when the message **“Replace waste ink bottle and press OK.”** is displayed, the counter is cleared automatically.

Maintenance

If you need to replace the waste ink bottle before the message is displayed, select **Replace Ink Bottle** from the setup menu.

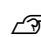
 [User's Guide \(Online Manual\)](#)

Important:

If you replace the Waste Ink Bottle before being prompted by a message, always clear the waste ink counter. Otherwise, the replacement interval for the Waste Ink Bottle will no longer be notified correctly from the next message.

Replacing the Waste Ink Bottle

Follow the procedure below to replace the parts.

Before starting this procedure, be sure to read the following:

 ["Precautions regarding maintenance" on page 26](#)

1

Remove the Waste Ink Bottle from the Waste Ink Bottle holder.

**SC-S80600 Series/SC-S60600 Series/
SC-S40600 Series**

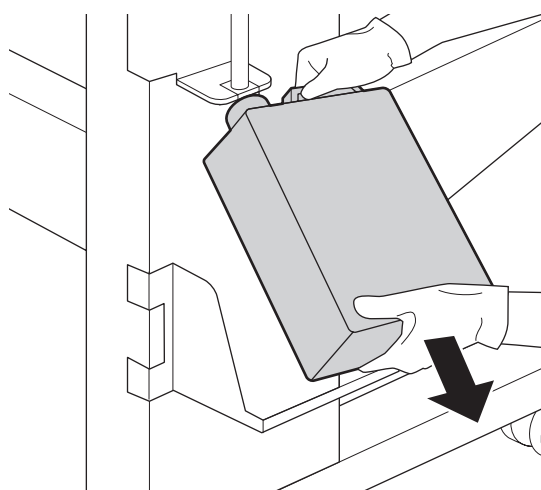
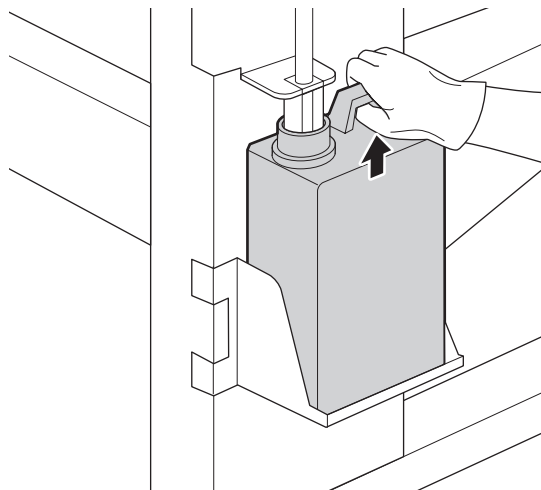

Maintenance

SC-S80600L Series/SC-S60600L Series

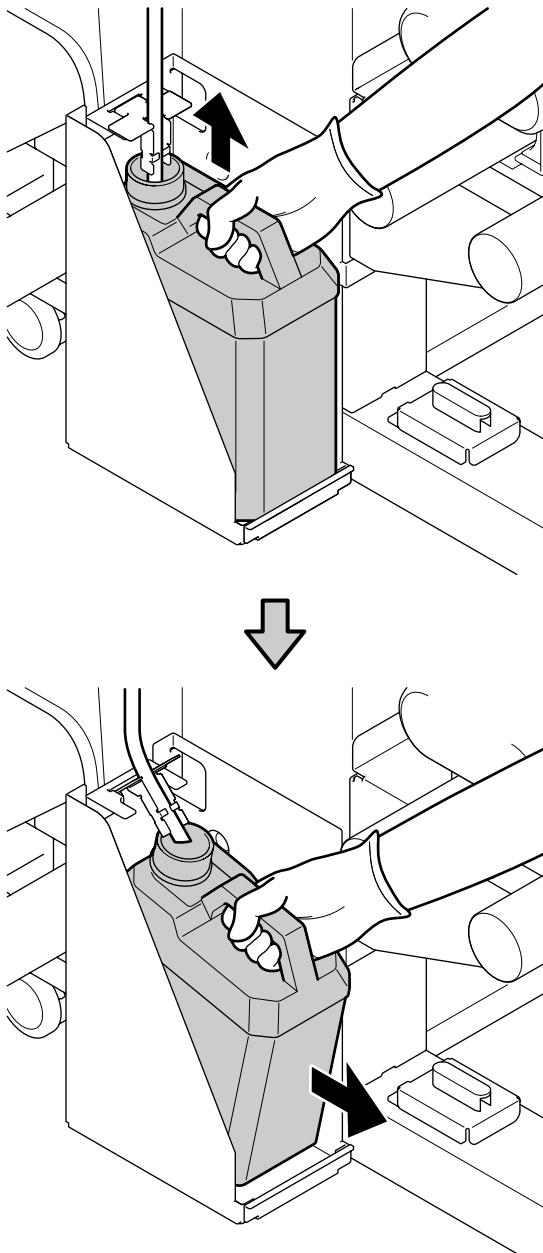

2 Insert the waste ink tube into the mouth of the new Waste Ink Bottle and place the Waste Ink Bottle in the holder.

Tightly seal the lid on the used Waste Ink Bottle.

! Important:

You will need the lid for the Waste Ink Bottle when disposing of waste ink. Keep the lid in a safe place; do not throw it out.

3 Press the OK button.

4 Check again to confirm that a new Waste Ink Bottle has been installed correctly. Press the OK button to clear the waste ink counter.

! Important:

Be sure to confirm that the waste ink tube is inserted in the mouth of the waste ink bottle. Ink will spill onto the surrounding area if the tube is not inserted in the bottle.

Leave the waste ink in the Waste Ink Bottle for disposal; do not transfer it to another container.

Disposing of used waste ink and Waste Ink Bottle "Disposal" on page 45

Replacing Maintenance Parts

Preparing and Replacement Timing

When "Maintenance parts are nearing end of life." is displayed

Prepare a new maintenance parts kit as soon as possible.

When you want to replace the parts at this stage due to night operations and so on, select **Replace Parts** from the setup menu, and then replace the parts. If you perform the replacement without selecting **Replace Parts**, the maintenance parts counter will not operate correctly.

Details on the setup menu *User's Guide* (Online Manual)

Maintenance

Important:

Maintenance Counter

The printer tracks amounts consumed using the maintenance counter and displays a message when the counter reaches the warning level.

If you replace parts when the message " **Replace Parts**" is displayed, the counter is cleared automatically.

If you need to replace the parts before the message is displayed, select **Replace Parts** from the setup menu.

 [User's Guide \(Online Manual\)](#)

When " Replace Parts" is displayed

Replace all parts supplied with the maintenance parts kit. Printing cannot be performed if the parts are not replaced.

Make sure you use the maintenance parts kit for this printer.

 ["Maintenance Items" on page 55](#)

The maintenance parts kit contains the following parts. Make sure you replace all of the maintenance parts at the same time.

- Wiper unit (x1)
- Flushing pad (x1)
- Air filters (x2)

Before starting this procedure, be sure to read the following:

 ["Precautions regarding maintenance" on page 26](#)

Replacement Procedure

- 1** When the message is displayed, press the OK button.

- 2** After the print head moves to the left end of the printer, open the right maintenance cover.

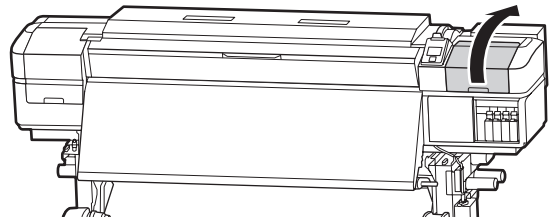

- 3** Place your fingers in the groove on the back of the wiper unit, and tilt it forward a little.

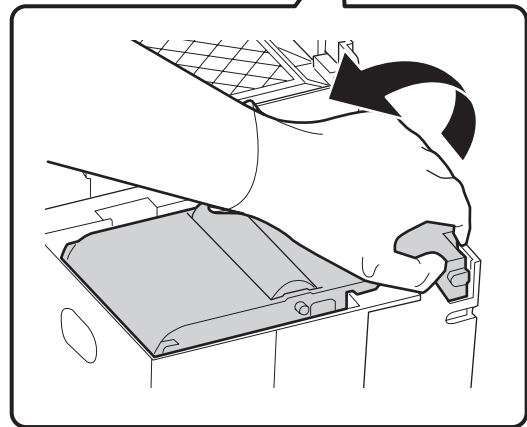
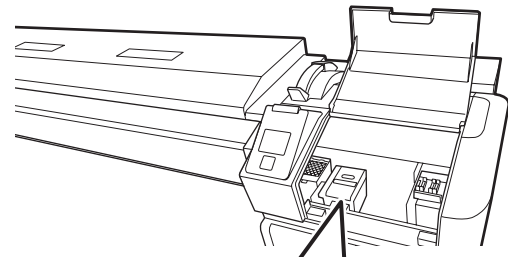

- 4** Grip the sides, and pull it straight up to lift it out.

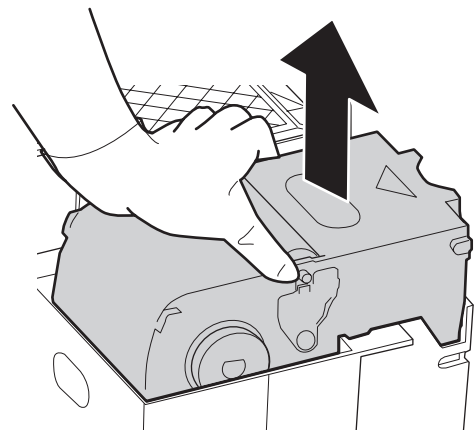

Maintenance

- 5** To avoid soiling your surroundings with ink, wrap the used wiper unit in the packaging supplied with the new wiper unit.

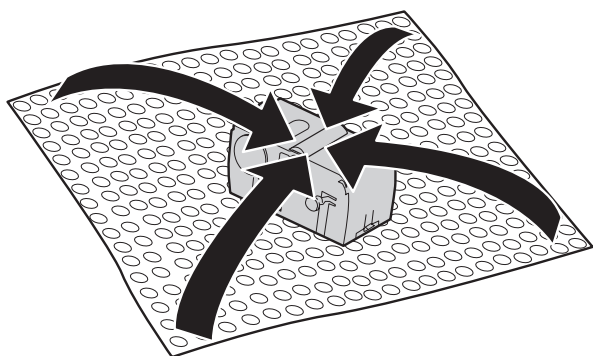

- 6** Insert the new wiper unit.
Place on the attachment point and press down until you hear a click.

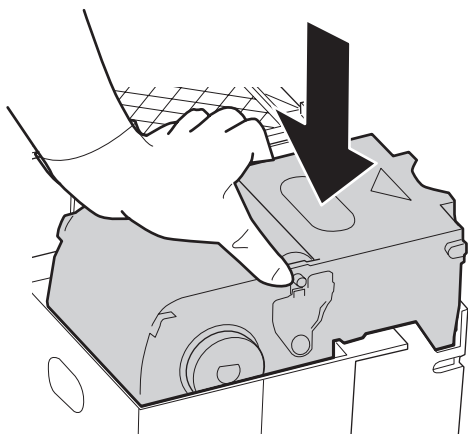

- 7** After replacing the wiper unit, press the OK button.

- 8** Lift up the tab on the flushing pad, and remove it.

Place the removed flushing pad on the metal tray so that ink does not adhere to the surroundings.

! Important:

Leave the used flushing pad that has been removed on the metal tray until it is disposed of. If such a part is directly placed on the printer, it may leave stains that may be difficult to remove due to the characteristics of the ink.

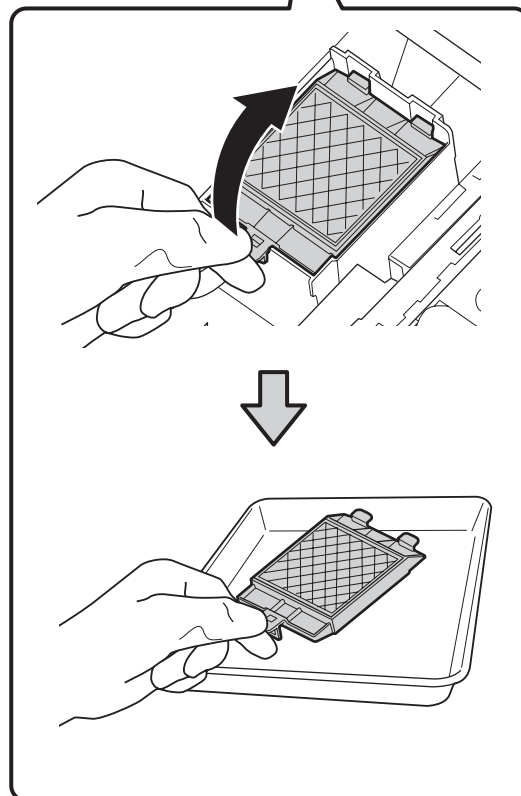
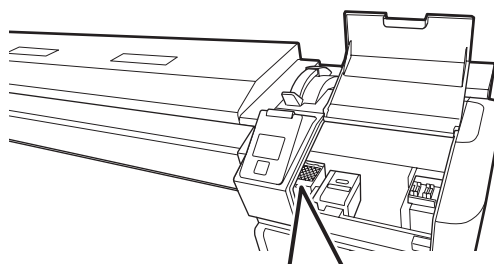

- 9** Insert the two hooks on the flushing pad into the slots on the printer and press the tab down until the pad clicks into place.

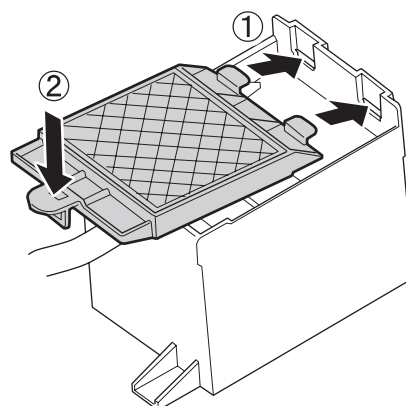

- 10** After replacing the flushing pad, press the OK button.

- 11** Remove both of the new air filters from the packaging.

Maintenance

- 12** Grip the air filters and lift them straight out.
Replace both of the air filters.

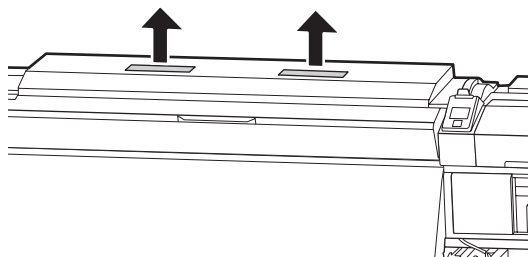

- 13** Place the removed air filters in the packaging that contained the new air filters.

- 14** Insert the new air filters.

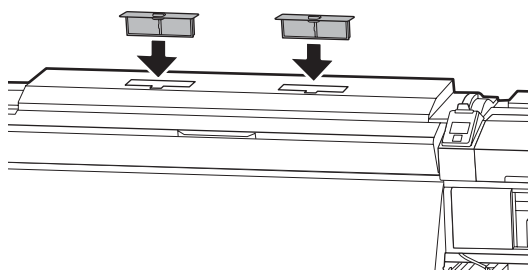

- 15** Check that the air filters are installed, and then press the OK button.

! **Important:**

Make sure you install the air filters.

If the printer is used when the air filters are not installed, sensors may degrade due to mist causing misalignment in print and the printer may malfunction.

- 16** Close the maintenance cover, and then press the OK button.

- 17** A confirmation message is displayed on the screen. Check the content of the message, select **Yes**, and then press the OK button.

Disposing of used maintenance parts  [“Disposal” on page 45](#)

Disposal of used consumables

Disposal

The following used parts with adhered ink are classified as industrial waste.

- Cleaning stick
- Clean-room wiper
- Ink cleaner
- Waste ink
- Waste Ink Bottle
- Wiper unit
- Flushing pad
- Air filter
- Media after printing
- Empty ink supply unit

Dispose of items according to local laws and regulations. For example, contract a industrial waste disposal company for disposal. In such cases, submit the “Safety data sheet” to the industrial waste disposal company.

You can download it at your local Epson Web site.

Maintenance

Consumable Replacement Check Sheet

Copy this page to track maintenance tasks.

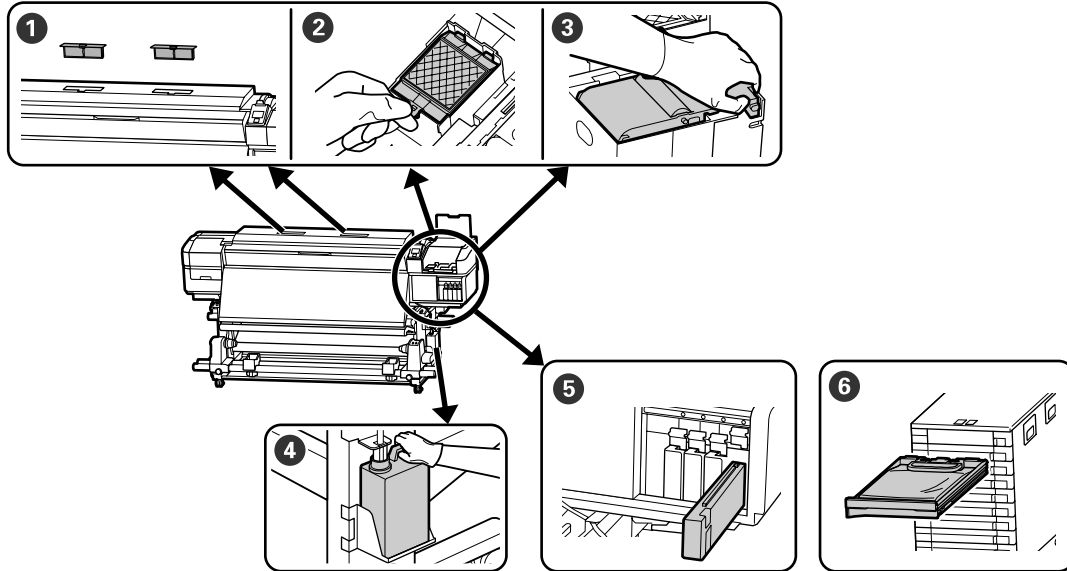

When to perform	Component to be replaced	Cleaned on date					
When a replacement message is displayed on the control panel screen	1 Air filters 2 Flushing pad 3 Wiper unit ⓘ "Replacing Maintenance Parts" on page 42	/	/	/	/	/	
		/	/	/	/	/	
		/	/	/	/	/	
	4 Waste Ink Bottle ⓘ "Disposing of Waste Ink" on page 40	/	/	/	/	/	
		/	/	/	/	/	
		/	/	/	/	/	
	5 Ink cartridge (SC-S80600 Series/ SC-S60600 Series/SC-S40600 Series) ⓘ "Replacement procedure" on page 35 6 Ink Supply Unit (SC-S80600L Series/ SC-S60600L Series) ⓘ "Replacement procedure" on page 38	/	/	/	/	/	
		/	/	/	/	/	
		/	/	/	/	/	
	When the plates are deformed or damaged	Media edge plates ⓘ User's Guide (Online Manual)	/	/	/	/	/

Maintenance

Long-term Storage (Pre-storage Maintenance)

Pre-storage Maintenance Timing

Always perform pre-storage maintenance if the printer will not be used (and will be turned off) for a long time.

If you do not print for a long time and do not perform pre-storage maintenance, turn the printer on at least once every seven days.

 **Important:**

If you do not perform pre-storage maintenance, a print head nozzle could become permanently clogged.

As shown below, the necessity of pre-storage maintenance depends on your model.

SC-S40600 Series/SC-S60600 Series/SC-S60600L Series

For pre-storage maintenance, use the number of cleaning cartridges/cleaning ink supply units (CL) shown for each model in the following table.

Interval	Number of CLs
1 month or more	SC-S40600 Series: 4 SC-S60600 Series: 8 SC-S60600L Series: 8

SC-S80600 Series/SC-S80600L Series

Due to the characteristics of WH/MS ink, it can be left for about six days.

When ink has not been used for 13 days or less, perform pre-storage maintenance for WH/MS ink only.

When the time span is two weeks or longer, pre-storage maintenance must be performed for all colors. For pre-storage maintenance, use the number of cleaning cartridges/cleaning ink supply units (CL) shown for each model in the following table.

For 10 color mode

Interval	Target color	Number of CLs
7 to 13 days	WH/MS	SC-S80600 Series: 2 SC-S80600L Series: 2
2 weeks or more	All colors (All Nozzles)	SC-S80600 Series: 10 SC-S80600L Series: 10

For 9 color mode

Interval	Target color	Number of CLs
2 weeks or more	All colors (All Nozzles)	SC-S80600 Series: 10 SC-S80600L Series: 10

 **Important:**

*If you want to perform **Pre-Storage Maint.** for **All Nozzles**, when it was already done only for WH/MS, switch on the power of the printer, fill the WH/MS ink, and then perform **Pre-Storage Maint.** again.*

Performing Pre-storage Maintenance

 **Important:**

If the amount of remaining ink or cleaning fluid is insufficient, the function may not run. When there is an insufficient amount remaining, have new cartridges on hand as a precaution.

Maintenance

Buttons that are used in the following settings

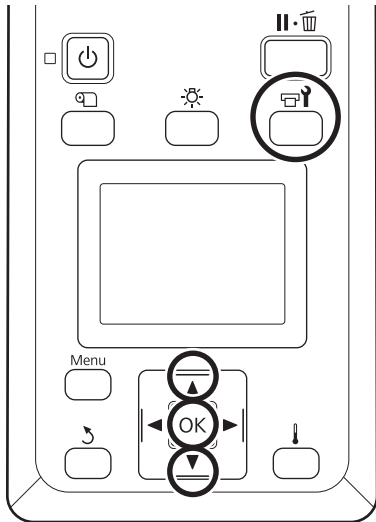

- 1 After confirming that the printer is ready, press the button.
The Maintenance menu will be displayed.
- 2 Use the **▲** button to select **Other maintenance**, and then press the OK button.
- 3 Use the **▼/▲** buttons to select **Pre-Storage Maint.**, and press the OK button.
- 4 Select **All Nozzles**, and then press the OK button.
For SC-S80600 Series/SC-S80600L Series (10 color mode), if you will not use the printer for less than 13 days, select **WH** or **MS**, depending on which ink is installed, and then press the OK button.
- 5 Then follow the on-screen instructions to replace the ink cartridge/ink supply unit.

Before storing them, clean off any ink stuck on ink supply ports of ink cartridges/ink supply units, which you removed.

Cleaning method

Lightly touch the corner of a cleaning stick from the supplied Maintenance Kit to the hole of the ink supply port to adsorb the ink, as shown in the illustration below. You do not need to wipe off the ink.

Use a new cleaning stick for each color to avoid mixing the colors. Do not forcefully press or move the cleaning stick.

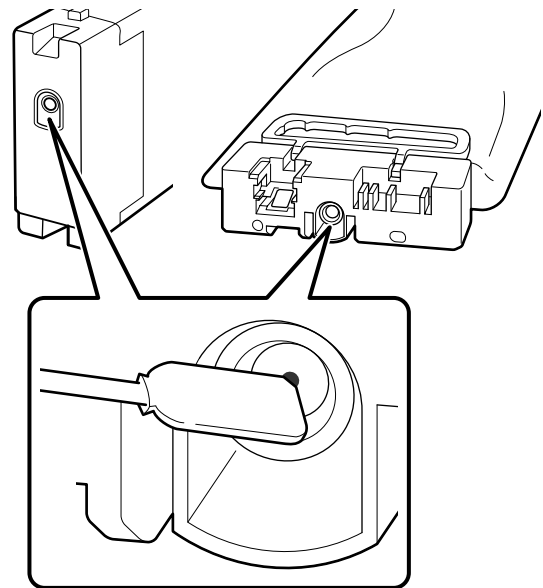

Observe the cautions on the *User's Guide* (Online Manual) when storing the printer and ink cartridges/ink supply units that were removed during use.

Restarting use of the printer

Important:

When restarting use of the printer, charge the printer with ink. When charging using removed ink cartridges, have new ink cartridges on hand as a precaution.

Switch on the power and follow the on-screen instructions.

When first printing after restarting use, perform a nozzle check and check that there are no clogs.

User's Guide (Online Manual)

Information on Maintenance Items

Information on Maintenance Items

For the latest information, see the Epson Web site. (as of June, 2019)

Epson recommends the use of genuine Epson ink cartridges/Ink Supply Unit. Epson cannot guarantee the quality or reliability of nongenuine ink. The use of non-genuine ink may cause damage that is not covered by Epson's warranties, and under certain circumstances, may cause erratic printer behavior.

Information about non-genuine ink levels may not be displayed, and use of non-genuine ink is recorded for possible use in service support.

Ink cartridges

For SC-S80600 Series/SC-S60600 Series/SC-S40600 Series

Printer model	Product	Part number	
SC-S80600	Ink cartridges	Black	T8901
		Cyan	T8902
		Magenta	T8903
		Yellow	T8904
		Light Cyan	T8905
		Light Magenta	T8906
		Light Black	T8907
		Orange	T8908
		Red	T8909
		White	T890A
		Metallic Silver	T890B

Information on Maintenance Items

Printer model	Product		Part number
SC-S80600 (Australia and New Zealand)	Ink cartridges	Black	T8331
		Cyan	T8332
		Magenta	T8333
		Yellow	T8334
		Light Cyan	T8335
		Light Magenta	T8336
		Light Black	T8337
		Orange	T8338
		Red	T8339
		White	T833A
		Metallic Silver	T833B
SC-S80610	Ink cartridges	Black	T8911
		Cyan	T8912
		Magenta	T8913
		Yellow	T8914
		Light Cyan	T8915
		Light Magenta	T8916
		Light Black	T8917
		Orange	T8918
		Red	T8919
		White	T891A
		Metallic Silver	T891B

Information on Maintenance Items

Printer model	Product		Part number
SC-S80670	Ink cartridges	Black	T8921
		Cyan	T8922
		Magenta	T8923
		Yellow	T8924
		Light Cyan	T8925
		Light Magenta	T8926
		Light Black	T8927
		Orange	T8928
		Red	T8929
		White	T892A
		Metallic Silver	T892B
SC-S80680	Ink cartridges	Black	T8931
		Cyan	T8932
		Magenta	T8933
		Yellow	T8934
		Light Cyan	T8935
		Light Magenta	T8936
		Light Black	T8937
		Orange	T8938
		Red	T8939
		White	T893A
		Metallic Silver	T893B
SC-S40600 SC-S60600	Ink cartridges	Black	T8901
		Cyan	T8902
		Magenta	T8903
		Yellow	T8904
SC-S40600 SC-S60600 (Australia and New Zealand)	Ink cartridges	Black	T8331
		Cyan	T8332
		Magenta	T8333
		Yellow	T8334

Information on Maintenance Items

Printer model	Product		Part number
SC-S40610 SC-S60610	Ink cartridges	Black	T8911
		Cyan	T8912
		Magenta	T8913
		Yellow	T8914
SC-S40670 SC-S60670	Ink cartridges	Black	T8921
		Cyan	T8922
		Magenta	T8923
		Yellow	T8924
SC-S40680 SC-S60680	Ink cartridges	Black	T8931
		Cyan	T8932
		Magenta	T8933
		Yellow	T8934

Ink Supply Unit

For SC-S80600L Series/SC-S60600L Series

Printer model	Product		Part number
SC-S80600L	Ink Supply Unit	Black	T45L1
		Cyan	T45L2
		Magenta	T45L3
		Yellow	T45L4
		Light Cyan	T45L5
		Light Magenta	T45L6
		Light Black	T45L7
		Orange	T45L8
		Red	T45L9
		White	T45LA
		Metallic Silver	T45LB

Information on Maintenance Items

Printer model	Product		Part number
SC-S80610L	Ink Supply Unit	Black	T45N1
		Cyan	T45N2
		Magenta	T45N3
		Yellow	T45N4
		Light Cyan	T45N5
		Light Magenta	T45N6
		Light Black	T45N7
		Orange	T45N8
		Red	T45N9
		White	T45NA
		Metallic Silver	T45NB
SC-S80660L	Ink Supply Unit	Black	T45M1
		Cyan	T45M2
		Magenta	T45M3
		Yellow	T45M4
		Light Cyan	T45M5
		Light Magenta	T45M6
		Light Black	T45M7
		Orange	T45M8
		Red	T45M9
		White	T45MA
		Metallic Silver	T45MB

Information on Maintenance Items

Printer model	Product		Part number
SC-S80670L	Ink Supply Unit	Black	T45P1
		Cyan	T45P2
		Magenta	T45P3
		Yellow	T45P4
		Light Cyan	T45P5
		Light Magenta	T45P6
		Light Black	T45P7
		Orange	T45P8
		Red	T45P9
		White	T45PA
		Metallic Silver	T45PB
SC-S80680L	Ink Supply Unit	Black	T45Q1
		Cyan	T45Q2
		Magenta	T45Q3
		Yellow	T45Q4
		Light Cyan	T45Q5
		Light Magenta	T45Q6
		Light Black	T45Q7
		Orange	T45Q8
		Red	T45Q9
		White	T45QA
		Metallic Silver	T45QB
SC-S60600L	Ink Supply Unit	Black	T45L1
		Cyan	T45L2
		Magenta	T45L3
		Yellow	T45L4
SC-S60610L	Ink Supply Unit	Black	T45N1
		Cyan	T45N2
		Magenta	T45N3
		Yellow	T45N4

Information on Maintenance Items

Printer model	Product		Part number
SC-S60660L	Ink Supply Unit	Black	T45M1
		Cyan	T45M2
		Magenta	T45M3
		Yellow	T45M4
SC-S60670L	Ink Supply Unit	Black	T45P1
		Cyan	T45P2
		Magenta	T45P3
		Yellow	T45P4
SC-S60680L	Ink Supply Unit	Black	T45Q1
		Cyan	T45Q2
		Magenta	T45Q3
		Yellow	T45Q4

Maintenance Items

For SC-S80600 Series/SC-S60600 Series/SC-S40600 Series

Product	Part number	Explanation
Cleaning cartridge	T6960	Use when performing Pre-Storage Maint..
Cleaning cartridge (Australia and New Zealand)	T8330	
Maintenance Parts Kit (except for SC-S40680/SC-S60680/ SC-S80680)	C13S210044	The following consumable items are included in one maintenance set. <ul style="list-style-type: none"> <input type="checkbox"/> Wiper unit (x1) <input type="checkbox"/> Flushing pad (x1) <input type="checkbox"/> Air filters (x2) <input type="checkbox"/> Gloves (x2)
Maintenance Parts Kit (for SC-S40680/SC-S60680/ SC-S80680)	C13S210045	
Ink Cleaner	T6993	Identical to the ink cleaner supplied with the printer.
Waste Ink Bottle	T7240	Identical to the Waste Ink Bottle supplied with the printer.
Cleaning Stick	C13S090013	Identical to the Maintenance Kit items supplied with the printer.
Clean Room Wiper*1	C13S090016	

*1 Not available for purchase in some countries and regions. We recommend BEMCOT M-3II by Asahi Kasei Corporation when purchasing commercial products.

Information on Maintenance Items

For SC-S80600L Series/SC-S60600L Series

Product	Part number	Explanation
Cleaning Ink Supply Unit (except for SC-S80660L/ SC-S60660L)	T44A5	Use when performing Pre-Storage Maint..
Cleaning Ink Supply Unit (for SC-S80660L/SC-S60660L)	T44A6	
Maintenance Parts Kit (except for SC-S80680L/ SC-S60680L)	C13S210093	The following consumable items are included in one maintenance set. <input type="checkbox"/> Wiper unit (x1) <input type="checkbox"/> Flushing pad (x1) <input type="checkbox"/> Air filters (x2) <input type="checkbox"/> Gloves (x2)
Maintenance Parts Kit (for SC-S80680L/SC-S60680L)	C13S210094	
Ink Cleaner	T6993	Identical to the ink cleaner supplied with the printer.
Waste Ink Bottle (except for SC-S80680L/ SC-S60680L)	C13S210071	Identical to the Waste Ink Bottle supplied with the printer.
Waste Ink Bottle (for SC-S80680L/SC-S60680L)	C13S210072	
Cleaning Stick	C13S090013	Identical to the Maintenance Kit items supplied with the printer.
Clean Room Wiper*1	C13S090016	

*1 Not available for purchase in some countries and regions. We recommend BEMCOT M-3II by Asahi Kasei Corporation when purchasing commercial products.

Handling Ink Drops and Clogged Nozzles

Handling Ink Drops and Clogged Nozzles

Problem

Try the solutions below if any of the following occurs in the print results.

Ink drops



Nozzles are clogged

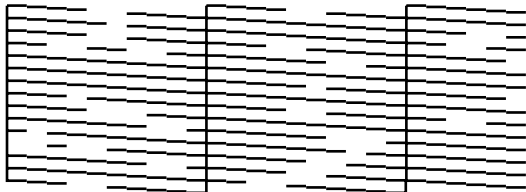

Solution

Perform the following sequence until the print results have improved.

1. Perform head cleaning

["Head Cleaning" on page 57](#)



2. Perform auto head maintenance

["Auto Head Maintenance" on page 58](#)



3. Perform regular cleaning

["Performing Regular Cleaning" on page 28](#)

Head Cleaning

There are three levels of head cleaning available: **Cleaning (Light)**, **Cleaning (Medium)**, and **Cleaning (Heavy)**.

Perform **Cleaning (Light)** first. After cleaning, print a check pattern and if there are still faint or missing segments, perform **Cleaning (Medium)**. If this still does not solve the problem, perform **Cleaning (Heavy)**.

Buttons that are used in the following settings

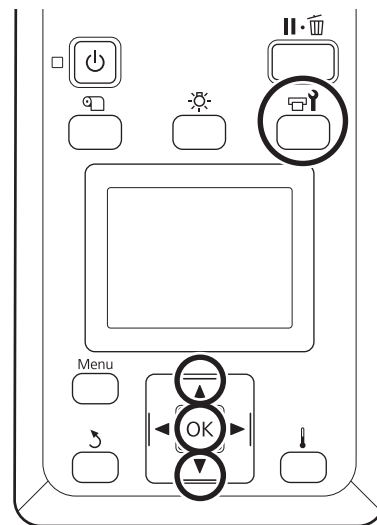

- 1** After confirming that the printer is ready, press the button.
The Maintenance menu will be displayed.
- 2** Use the / buttons to select **Cleaning** and press the OK button.
- 3** Select a cleaning level, and then press the OK button.
Select **Cleaning (Light)** first.
Next, select **Cleaning (Medium)**.
And finally, select **Cleaning (Heavy)**.
- 4** Select the cleaning method you want to use for each row of nozzles.
When **Cleaning (Light)** is selected, only **All Nozzles** is available.

Handling Ink Drops and Clogged Nozzles

All Nozzles

Select this if there are any faint or missing segments in all of the printed check patterns. After making your selections, proceed to Step 6.

Head1/Head2

Only displayed for SC-S80600 Series/SC-S80600L Series/SC-S60600 Series/SC-S60600L Series.

Select this if there are faint or missing segments in only one of the print heads. After making your selections, proceed to Step 6.

Selected Nozzles

Select this if there are faint or missing segments in only some of the numbered patterns (nozzle arrays) in the check pattern. You can select multiple nozzle arrays.

5 Choose the nozzle arrays to be cleaned.

- (1) Use the ▼/▲ buttons to choose the nozzle arrays with faint or missing segments in the nozzle check pattern, and then press the OK button.
- (2) After selecting the arrays you want to clean, select **Execute With Selection**, and then press the OK button.

6 Head cleaning starts.

A confirmation message is displayed when cleaning is complete.

7 To print a check pattern and check the status of the clog, use the ▼/▲ buttons to select **Nozzle Check**, and then press the OK button.

When printing a check pattern in the margin of media on which a check pattern has already been printed, press the ▲ button to move the print start position to the pressure rollers position.

8 Select the desired print position, and then press the OK button.

Select **Print At Center** or **Print At Left** to print in a side margin where a check pattern has already been printed. The displayed content changes depending on the width of the loaded media.

Press the OK button to print a check pattern.

9 Cut the media as necessary, and then check the printed patterns.

No faint or missing segments

Continue with normal operations.

Faint or missing segments

Return to Step 1, and go to the next level of head cleaning.

If nozzles are still clogged even after performing Cleaning (Heavy)

The areas around the print heads may be soiled. Perform **Auto Head Maintenance** in the following section.

Auto Head Maintenance

Perform Auto Head Maintenance if ink drops or clogged nozzles remain even after performing head cleaning.

! Important:

Do not perform auto head maintenance repeatedly in one day. Using this feature too frequently could damage the print heads.

Buttons that are used in the following settings

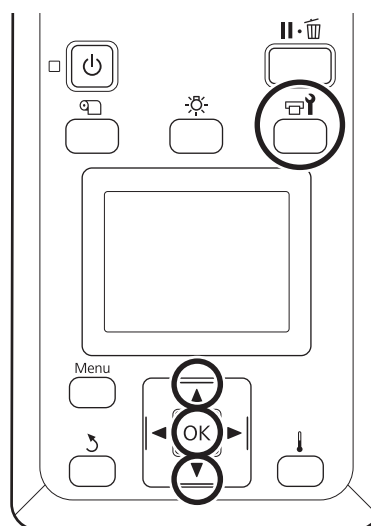

1 After confirming that the printer is ready, press the maintenance button.

The Maintenance menu will be displayed.

Handling Ink Drops and Clogged Nozzles

- 2** Use the ▼/▲ buttons to select **Head Maintenance** and press the OK button.
- 3** Check that **Auto Head Maintenance** is highlighted, and then press the OK button.
- 4** Press the OK button.
Auto Head Maintenance starts.
When Auto Head Maintenance is complete, the setup menu closes.

If ink drops or clogged nozzles remain even after performing Auto Head Maintenance, clean around the print heads and the caps.

 [“Performing Regular Cleaning” on page 28](#)